

**Gurtbreite 1000 mm
Belt width 1000 mm**

Stationen
Rollen
Girlanden
Trommeln

Frames
Rollers
Garlands
Pulleys

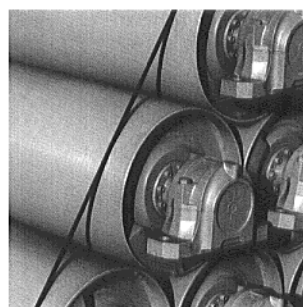
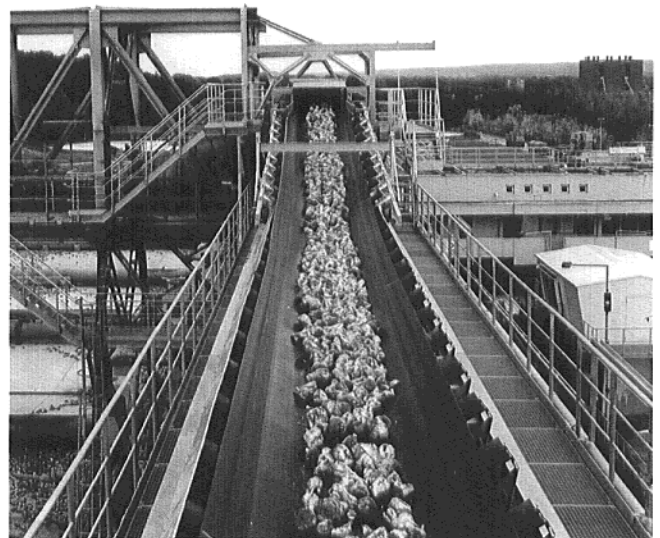

Gurtbreite 1000 mm
Belt width 1000 mm





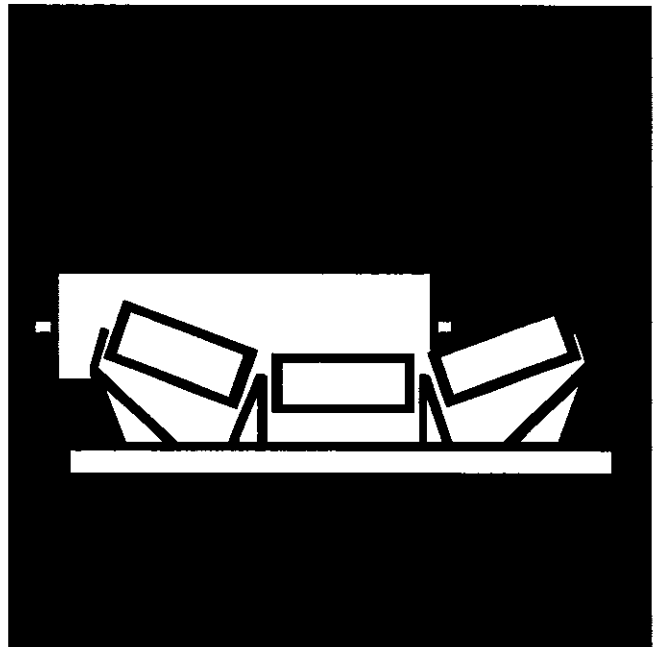

Stationen
Rollen

Frames
Rollers

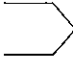
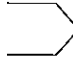
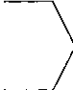
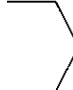

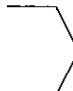
Inhalt Gurtbreite 1000 mm

Contents Belt width 1000 mm

| | | | | Blatt / Sheet | | |
|--------------------------------|-------------------------------------|--|-------------------|--|---|--|
| Station Rolle | Obergurt Obergurt |  | 1-teilig flach | 2.05.01 2.05.02 | Frame Carry roller |  single roll flat idler |
| Station Rolle Polsterrollen | Obergurt Obergurt Obergurt |  | 3-teilig gemuldet | 2.05.05 2.05.06 2.05.07 | Frame Carry roller Impact rollers |  3 roll trough idler |
| Station Rolle Stützringe | Untergurt Untergurt Untergurt |  | 1-teilig flach | 2.05.08 2.05.09 2.05.10 | Frame Return roller Rubber disc's |  single roll flat idler |
| Station Rolle Stützringe | Untergurt Untergurt Untergurt |  | 2-teilig gemuldet | 2.05.11 2.05.12 2.05.13 | Frame Return roller Rubber disc's |  2 roll flat idler |
| Dachstation Rollen | Untergurt Untergurt |  | 2-teilig gemuldet | 2.05.14 2.05.12 | Roof frame Return rollers |  2 roll trough idler |

| | | | |
|--|---|--|--------------------|
| <p>FLACHGURT-STATIONEN FRAMES FOR FLAT BELT</p> |  | <p>OBERGURT CARRYING BELT</p> | <p>1000</p> |
|--|---|--|--------------------|

Ausführung 1 / Design 1

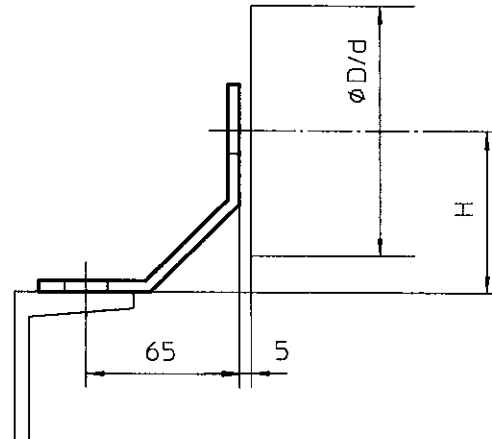
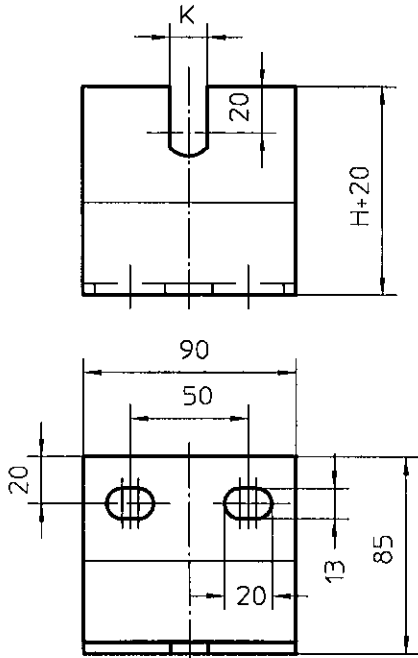

| D | H | K | Achs ø d1 Shaft ø d1 | SW** | Masse/kg pro Stück Mass/kg per piece | |
|------|-----|-----|-------------------------------|------|---|-----|
| | | | | | 1 | 2 |
| 63,5 | 70 | 15 | 20 | 14 | 0,5 | 0,8 |
| 89 | | 16 | 20 | 15 | | |
| 108 | | 19 | 25 | 18 | | |
| | | 31* | 20 | 30 | | |
| 133 | 100 | 15 | 20 | 14 | 0,7 | 1,0 |
| 159 | | 16 | 20 | 15 | | |
| | | 19 | 25 | 18 | | |
| | | 31* | 20 | 30 | | |

* Aufsteckkappen / Adaptor caps

** SW = Schlüsselweite / width across flat

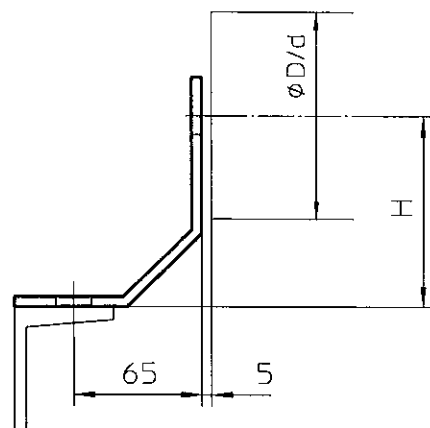
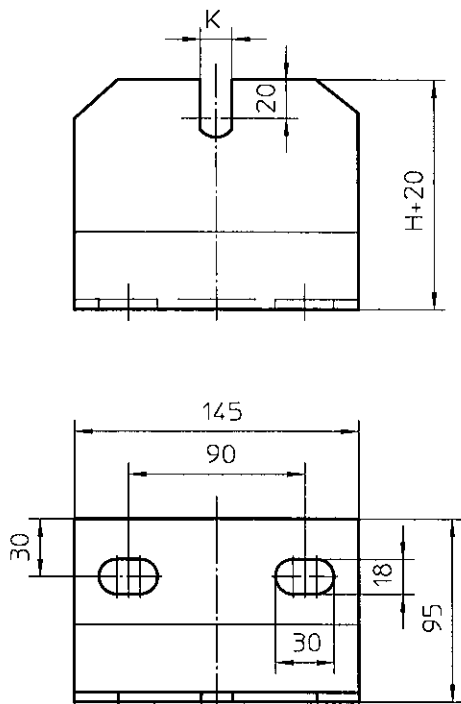

Ausführung 2 / Design 2

Bestellangaben:
Order details:

Flachgurt-Stationen. Ausführung 1 H = 100, K = 16
Frames for flat belt. Design 1 H = 100, K = 16

Rollen siehe Blatt Nr. 2.05.02
Rollers refer to Sheet No. 2.05.02

| | | | |
|---------------------------|---|-----------------------------------|-------------|
| ROLLEN ROLLERS |  | OBERGURT CARRYING BELT | 1000 |
|---------------------------|---|-----------------------------------|-------------|

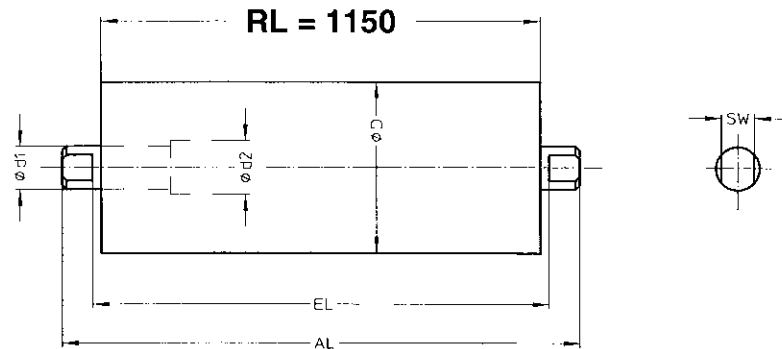

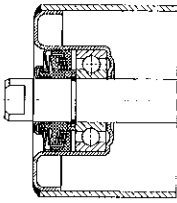
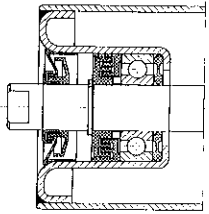
| Rollentyp Roller type | D | Achsdurchmesser d1 / Shaft diameter Kugellager / Ball bearings | | | | | | | | | | | |
|---|------|---|---------------------------------|---------------|---------------------------------|--------------|---------------------------------|--------------|---------------------------------|--------------|---------------------------------|--------------|---------------------------------|
| | | 20 6204 | | 25/20 6204 | | 25 6205 | | 25 6305 | | 30 6206 | | 30 6306 | |
| | | Masse in kg / Mass in kg | | | | | | | | | | | |
| | | kpl. cpl. | dreh. Teile rot. parts | kpl. cpl. | dreh. Teile rot. parts | kpl. cpl. | dreh. Teile rot. parts | kpl. cpl. | dreh. Teile rot. parts | kpl. cpl. | dreh. Teile rot. parts | kpl. cpl. | dreh. Teile rot. parts |
| SE  | 63,5 | 6,5 | 3,5 | 8,0 | 3,5 | | | | | | | | |
| | 89 | 10,1 | 7,2 | 11,6 | 7,2 | | | | | | | | |
| | 108 | 11,7 | 8,7 | 13,2 | 8,7 | | | | | | | | |
| | 133 | 17,3 | 14,2 | 18,6 | 14,2 | | | | | | | | |
| ML  | 63,5 | | | 9,9 | 5,5 | 10,5 | 5,8 | | | | | | |
| | 89 | | | 12,0 | 7,5 | 12,2 | 7,5 | 12,5 | 7,8 | 14,4 | 7,7 | 20,5 | 13,7 |
| | 108 | | | 15,3 | 10,9 | 15,3 | 10,6 | 15,6 | 10,8 | 17,4 | 10,7 | 18,3 | 11,5 |
| | 133 | | | 20,9 | 16,5 | 20,8 | 16,1 | 21,3 | 16,6 | 23,2 | 16,5 | 24,0 | 17,1 |
| | 159 | | | | | 26,3 | 21,6 | 26,5 | 21,7 | 28,3 | 17,8 | 28,9 | 22,0 |

| Anschlußmaße / Connecting dimensions | | | | | | |
|--|-----|------|--|----|------|------|
| Achsenden A2 nach DIN 15207 von 1960 Shaft ends A2 to DIN 15207 dtd. 1960 | | | Achsenden A2 nach DIN 15207 von 1988 Shaft ends A2 to DIN 15207 dtd. 1988 | | | |
| d1 | SW | EL | AL | SW | EL | AL |
| 20 | 15* | 1156 | 1182 | 14 | 1158 | 1182 |
| 25 | | | | 18 | 1158 | 1182 |
| 30 | | | | 22 | 1158 | 1182 |

* Bei Rollen mit Achsdurchmesser 20 mm empfehlen wir die vom Markt bevorzugte Ausführung mit SW 15. / For rollers with the shaft diameter 20 mm we recommend the design with presently enjoys market preference.

Bestellangaben: Rollen Typ; D; d2/d1; RL; Kugellager; SW, z. B.: Rolle ML, 108, 25/20, 1150 – 6204/15. Die Angabe d2 ist nur erforderlich, wenn d2 > als d1 sein muß.
Order details: Roller type; D; d2/d1; RL; ball bearing; SW, e.g.: Roller ML, 108, 25/20, 1150 – 6204/15. Detail d2 is only necessary when d2 must be > than d1.

| | | |
|-----------------------------|---|-----------------------------------|
| STATIONEN FRAMES |  | OBERGURT CARRYING BELT |
| | | 1000 |

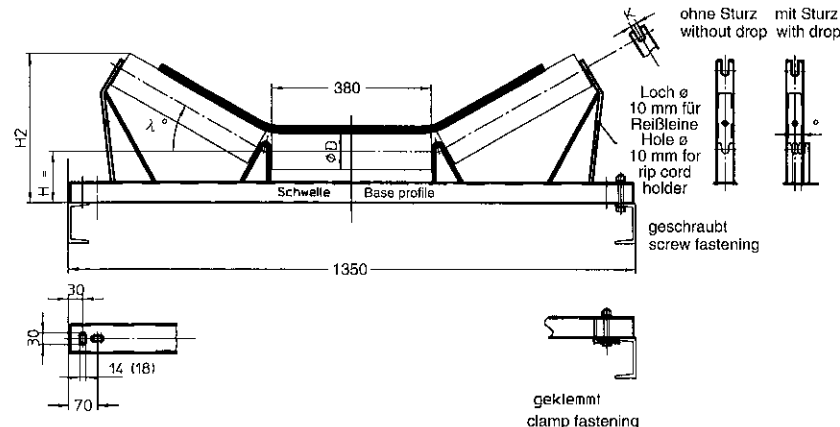

| Klinkung K Slot K | SW** | Achs ø Shaft ø |
|----------------------|------|-------------------|
| 15 | 14 | 20 |
| 16 | 15 | 20 |
| 19 | 18 | 25 |
| 23 | 22 | 30 |
| 31* | 30 | 20 |

* Aufsteckkappen / Adaptor caps
 ** Schlüsselweite / width across flat

| Schwelle Base profile | D | H | H 2 bei 30° H 2 at 30° | Masse in kg o. Rollen bei Mass in kg without rollers at | | | |
|--|--------------------------|-------------------|---------------------------------|--|------------------------------|------------------------------|------------------------------|
| | | | | λ 15° | λ 20° | λ 30° | λ 35° |
| U 70 x 50 x 4 kaltgewalzt U 70 x 50 x 4 cold-rolled | 89 108 | 125 | 362 370 | 8,4 | 8,6 | 8,9 | 9,2 |
| U 100 x 50 x 5 kaltgewalzt U 100 x 50 x 5 cold-rolled | 89 108 133 | 125 150 | 362 370 410 | 11,8 12,0 | 12,1 12,3 | 12,5 12,7 | 12,8 13,0 |
| U 100 warmgewalzt U 100 hot-rolled | 89 108 133 | 125 150 | 362 370 410 | 17,5 17,7 | 17,9 18,2 | 18,5 18,7 | 18,9 19,1 |
| U 120 warmgewalzt U 120 hot-rolled | 108 133 159 180 | 130 155 185 | 375 415 460 470 | 22,1 22,5 22,8 22,8 | 22,5 23,0 23,2 23,2 | 23,0 23,5 23,8 23,8 | 23,4 23,9 24,2 24,2 |

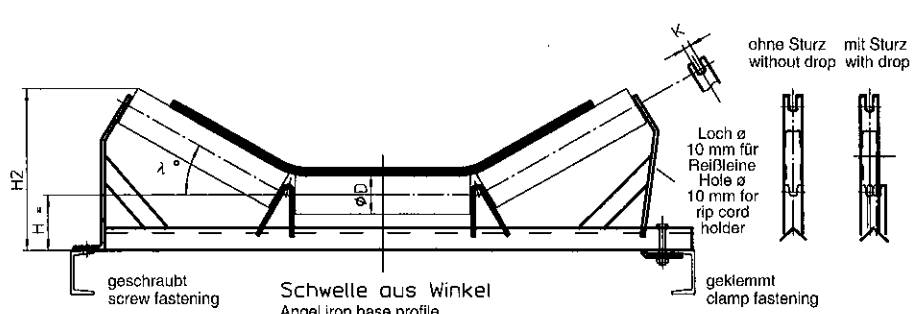

| Klinkung K Slot K | SW** | Achs ø Shaft ø |
|----------------------|------|-------------------|
| 15 | 14 | 20 |
| 16 | 15 | 20 |
| 19 | 18 | 25 |
| 23 | 22 | 30 |
| 31* | 30 | 20 |

* Aufsteckkappen / Adaptor caps
 ** Schlüsselweite / width across flat

| Schwelle Base profile | D | H | H 2 bei 30° H 2 at 30° | Masse in kg o. Rollen bei Mass in kg without rollers at | | | |
|--------------------------|--------------------------|-------------------|---------------------------------|--|------------------------------|------------------------------|------------------------------|
| | | | | λ 15° | λ 20° | λ 30° | λ 35° |
| ↘ 70 x 70 x 7 | 89 108 133 | 125 150 | 362 370 410 | 13,4 13,6 | 13,8 14,0 | 14,4 14,6 | 14,8 15,0 |
| ↘ 80 x 80 x 8 | 108 133 159 180 | 130 155 185 | 375 415 460 470 | 16,9 17,1 17,3 17,3 | 17,9 18,1 18,4 18,4 | 18,5 18,7 19,1 19,1 | 18,8 19,0 19,3 19,3 |

Bestellangaben: 3-tlg. OB-Station. GB-1000, λ 30°, K = 16 für Ro. ø 89 mm, ohne Sturz. Schwelle U 70
 Rollen siehe Blatt Nr. 2.05.06 / Befestigungsmaterial siehe Kapitel Zubehör
Order details: 3-part CB-Frame, BW-1000, λ 30°, K = 16, for Ro. Dia. 89 mm, without drop, base profile U 70
 Rollers refer to Sheet No. 2.05.06 / Fastening material, refer to chapter Accessories

| | | | |
|---------------------------|---|-----------------------------------|-------------|
| ROLLEN ROLLERS |  | OBERGURT CARRYING BELT | 1000 |
|---------------------------|---|-----------------------------------|-------------|

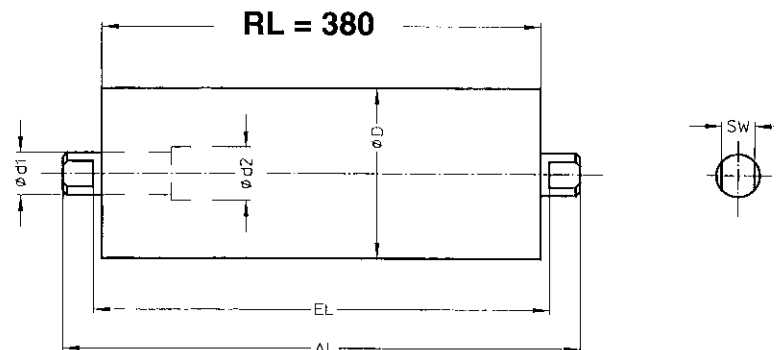

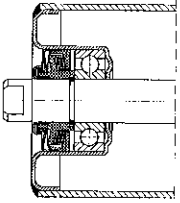
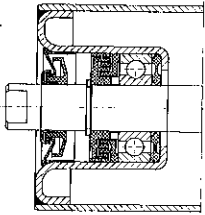
| Rollentyp Roller type | D | Achsdurchmesser d1 / Shaft diameter Kugellager / Ball bearings | | | | | | | | | |
|--|-----|---|---------------------------------|--------------|---------------------------------|--------------|---------------------------------|--------------|---------------------------------|--------------|---------------------------------|
| | | 20 6204 | | 25 6205 | | 25 6305 | | 30 6206 | | 30 6306 | |
| | | Masse in kg / Mass in kg | | | | | | | | | |
| | | kpl. cpl. | dreh. Teile rot. parts | kpl. cpl. | dreh. Teile rot. parts | kpl. cpl. | dreh. Teile rot. parts | kpl. cpl. | dreh. Teile rot. parts | kpl. cpl. | dreh. Teile rot. parts |
| SE  | 89 | 3,8 | 2,7 | | | | | | | | |
| | 108 | 4,5 | 3,4 | | | | | | | | |
| | 133 | 6,6 | 5,3 | | | | | | | | |
| ML  | 89 | 4,2 | 3,1 | 4,9 | 3,1 | 5,1 | 3,3 | 5,7 | 3,2 | 8,3 | 5,7 |
| | 108 | 5,7 | 4,5 | 5,9 | 4,2 | 6,2 | 4,4 | 6,8 | 4,3 | 7,6 | 5,1 |
| | 133 | 7,8 | 6,6 | 8,0 | 6,3 | 8,5 | 6,7 | 9,1 | 6,6 | 9,8 | 7,2 |
| | 159 | | | 10,4 | 8,6 | 10,5 | 8,8 | 11,1 | 8,7 | 11,6 | 9,1 |

| Anschlußmaße / Connecting dimensions | | | | | | |
|--------------------------------------|--|-----|-----|--|-----|-----|
| d1 | Achsenden A2 nach DIN 15207 von 1960 Shaft ends A2 to DIN 15207 dtd. 1960 | | | Achsenden A2 nach DIN 15207 von 1988 Shaft ends A2 to DIN 15207 dtd. 1988 | | |
| | SW | EL | AL | SW | EL | AL |
| 20 | 15* | 386 | 406 | 14 | 388 | 406 |
| 25 | | | | 18 | 388 | 412 |
| 30 | | | | 22 | 388 | 412 |

* Bei Rollen mit Achsdurchmesser 20 mm empfehlen wir die vom Markt bevorzugte Ausführung mit SW 15. / For rollers with the shaft diameter 20 mm we recoment the design with presently enjoys market preference.

Bestellangaben: Rolle Typ; D; d2/d1; RL; Kugellager; SW, z. B.: Rolle ML 108; 20; 380 – 6204/15. Die Angabe d2 ist nur erforderlich, wenn d2 > als d1 sein muß.
Order details: Roller type; D; d2/d1; RL; ball bearing; SW, e.g.: Roller ML 108; 20; 380 – 6204/15. Detail d2 is only necessary when d2 must be > than d1.

| | | | |
|---|--|-----------------------------------|-------------|
| POLSTERROLLEN IMPACT ROLLERS | | OBERGURT CARRYING BELT | 1000 |
|---|--|-----------------------------------|-------------|

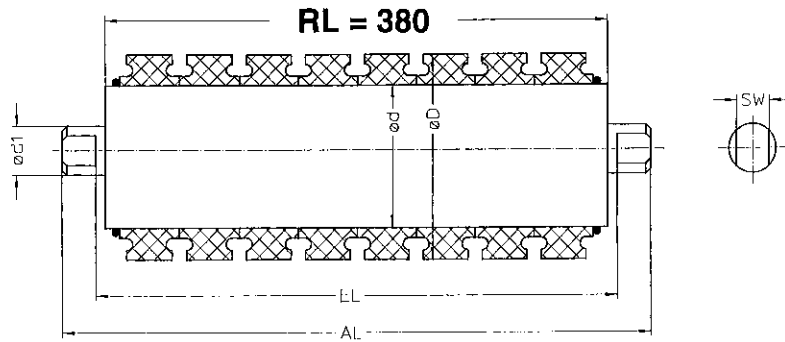

| Rollentyp Roller type | d | D | Achsdurchmesser d1 / Shaft diameter Kugellager / Ball bearings | | | | | | | | | |
|--------------------------|------|-----|---|---------------------------------|--------------|---------------------------------|--------------|---------------------------------|--------------|---------------------------------|--------------|---------------------------------|
| | | | 20 6204 | | 25 6205 | | 25 6305 | | 30 6206 | | 30 6306 | |
| | | | Masse in kg / Mass in kg | | | | | | | | | |
| | | | kpl. cpl. | dreh. Teile rot. parts | kpl. cpl. | dreh. Teile rot. parts | kpl. cpl. | dreh. Teile rot. parts | kpl. cpl. | dreh. Teile rot. parts | kpl. cpl. | dreh. Teile rot. parts |
| SE | 63,5 | 89 | 4,0 | 2,9 | | | | | | | | |
| | 63,5 | 108 | 4,6 | 3,5 | | | | | | | | |
| | 89 | 133 | 6,5 | 5,4 | | | | | | | | |
| | 89 | 159 | 7,8 | 6,7 | | | | | | | | |
| | 108 | 159 | 8,5 | 7,4 | | | | | | | | |
| | 108 | 180 | 10,2 | 9,1 | | | | | | | | |
| ML | 63,5 | 89 | 4,7 | 3,5 | 5,6 | 3,9 | | | | | | |
| | 63,5 | 108 | 5,3 | 4,1 | 6,2 | 4,5 | | | | | | |
| | 89 | 133 | 6,9 | 5,8 | 7,5 | 5,8 | 7,8 | 6,0 | 8,4 | 5,9 | 11,0 | 8,4 |
| | 89 | 159 | 8,2 | 7,1 | 8,8 | 7,1 | 9,1 | 7,3 | 9,7 | 7,2 | 12,3 | 9,7 |
| | 108 | 159 | 9,6 | 8,5 | 9,9 | 8,2 | 10,2 | 8,4 | 10,8 | 8,3 | 11,6 | 9,0 |
| | 108 | 180 | 11,3 | 10,2 | 11,6 | 9,9 | 11,9 | 10,1 | 12,5 | 10,0 | 13,3 | 10,7 |

| Anschlußmaße / Connecting dimensions | | | | | | |
|--|-----|-----|-----|--|-----|-----|
| Achsenden A2 nach DIN 15207 von 1960 Shaft ends A2 to DIN 15207 dtd. 1960 | | | | Achsenden A2 nach DIN 15207 von 1988 Shaft ends A2 to DIN 15207 dtd. 1988 | | |
| d1 | SW | EL | AL | SW | EL | AL |
| 20 | 15* | 386 | 406 | 14 | 388 | 406 |
| 25 | | | | 18 | 388 | 412 |
| 30 | | | | 22 | 388 | 412 |

* Bei Rollen mit Achsdurchmesser 20 mm empfehlen wir die vom Markt bevorzugte Ausführung mit SW 15. / For rollers with the shaft diameter 20 mm we recommend the design with presently enjoys market preference.

Bestellangaben: Rolle Typ; D/d; d2/d1; RL; Kugellager; SW, z. B.: Polsterrolle ML 108/63,5; 20; 380 – 6204/15. Die Angabe d2 ist nur erforderlich, wenn d2 > als d1 sein muß.
Order details: Roller type; D/d; d2/d1; RL; ball bearing; SW, e.g.: impact roller ML 108/63,5; 20; 380 – 6204/15. Detail d2 is only necessary when d2 must be > than d1.

**UNTERGURT-STATIONEN
FRAMES FOR RETURN BELT**



**UNTERGURT
RETURN BELT**

1000

Ausführung 1 / Design 1

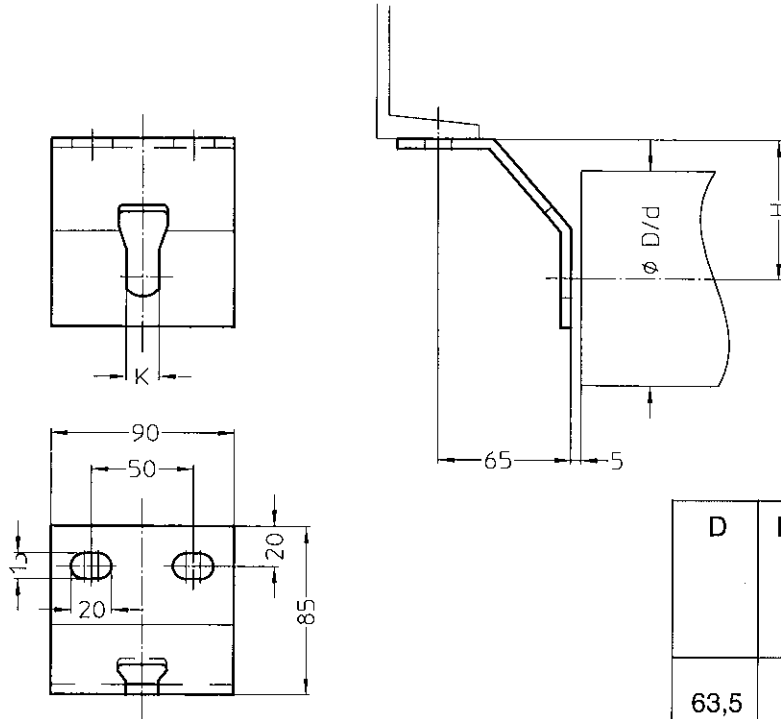

| D | H | K | Achs $\phi d1$ Shaft $\phi d1$ | SW** | Masse/kg pro Stück Mass/kg per piece | |
|------|-----|-----|---|------|---|-----|
| | | | | | 1 | 2 |
| 63,5 | 70 | 15 | 20 | 14 | 0,5 | 0,8 |
| 89 | | 16 | 20 | 15 | | |
| 108 | | 19 | 25 | 18 | | |
| | | 31* | 20 | 30 | | |
| 133 | 100 | 15 | 20 | 14 | 0,7 | 1,0 |
| | | 16 | 20 | 15 | | |
| | | 19 | 25 | 18 | | |
| 159 | | 31* | 20 | 30 | | |

* Aufsteckkappen / Adaptor caps
** SW = Schlüsselweite / width across flat

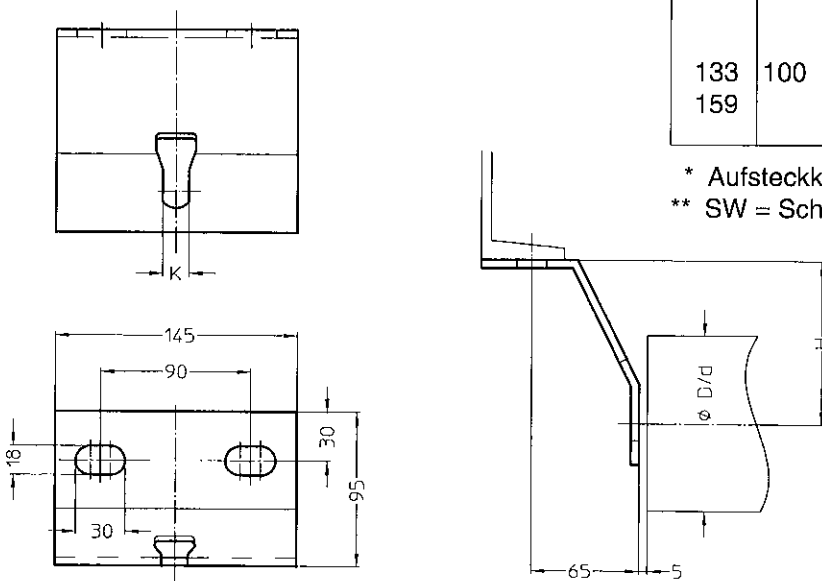

Ausführung 2 / Design 2

Bestellangaben: Untergurt-Stationen, Ausführung 1 H = 100, K = 16
Order details: Frame for return belt, Design 1 H = 100, K = 16

Rollen siehe Blatt Nr. 2.05.09
Rollers refer to Sheet No. 2.05.09

| | | | |
|---------------------------|---|----------------------------------|-------------|
| ROLLEN ROLLERS |  | UNTERGURT RETURN BELT | 1000 |
|---------------------------|---|----------------------------------|-------------|

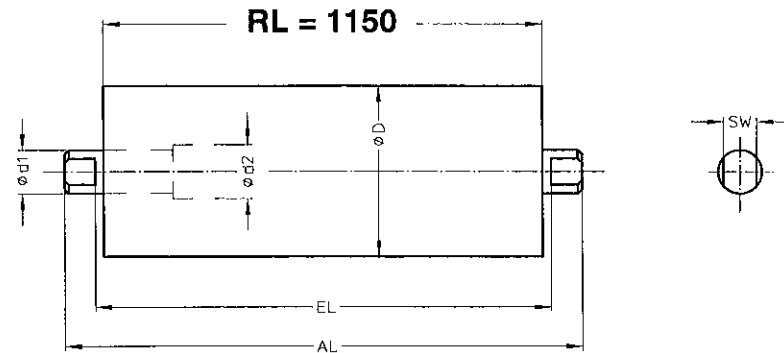

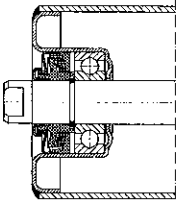
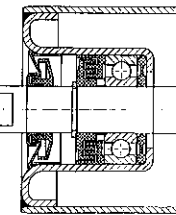
| | | | | | | | | | | | | | |
|---|------|---|---------------------------------|--------------|---------------------------------|--------------|---------------------------------|--------------|---------------------------------|--------------|---------------------------------|--------------|---------------------------------|
| Rollentyp Roller type | D | Achsdurchmesser d1 / Shaft diameter Kugellager / Ball bearings | | | | | | | | | | | |
| | | 20 6204 | 25/20 6204 | 25 6205 | 25 6305 | 30 6206 | 30 6306 | | | | | | |
| | | Masse in kg / Mass in kg | | | | | | | | | | | |
| | | kpl. cpl. | dreh. Teile rot. parts | kpl. cpl. | dreh. Teile rot. parts | kpl. cpl. | dreh. Teile rot. parts | kpl. cpl. | dreh. Teile rot. parts | kpl. cpl. | dreh. Teile rot. parts | kpl. cpl. | dreh. Teile rot. parts |
| SE  | 63,5 | 6,5 | 3,5 | 8,0 | 3,5 | | | | | | | | |
| | 89 | 10,1 | 7,2 | 11,6 | 7,2 | | | | | | | | |
| | 108 | 11,7 | 8,7 | 13,2 | 8,7 | | | | | | | | |
| | 133 | 17,3 | 14,2 | 18,6 | 14,2 | | | | | | | | |
| ML  | 63,5 | | | 9,9 | 5,5 | 10,5 | 5,8 | | | | | | |
| | 89 | | | 12,0 | 7,5 | 12,2 | 7,5 | 12,5 | 7,8 | 14,4 | 7,7 | 20,5 | 13,7 |
| | 108 | | | 15,3 | 10,9 | 15,3 | 10,6 | 15,6 | 10,8 | 17,4 | 10,7 | 18,3 | 11,5 |
| | 133 | | | 20,9 | 16,5 | 20,8 | 16,1 | 21,3 | 16,6 | 23,2 | 16,5 | 24,0 | 17,1 |
| | 159 | | | | | 26,3 | 21,6 | 26,5 | 21,7 | 28,3 | 17,8 | 28,9 | 22,0 |

| | | | | | | |
|--|-----|------|--|----|------|------|
| Anschlußmaße / Connecting dimensions | | | | | | |
| Achsenden A2 nach DIN 15207 von 1960 Shaft ends A2 to DIN 15207 dtd. 1960 | | | Achsenden A2 nach DIN 15207 von 1988 Shaft ends A2 to DIN 15207 dtd. 1988 | | | |
| d1 | SW | EL | AL | SW | EL | AL |
| 20 | 15* | 1156 | 1182 | 14 | 1158 | 1182 |
| 25 | | | | 18 | 1158 | 1182 |
| 30 | | | | 22 | 1158 | 1182 |

* Bei Rollen mit Achsdurchmesser 20 mm empfehlen wir die vom Markt bevorzugte Ausführung mit SW 15. / For rollers with the shaft diameter 20 mm we recoment the design with presently enjoys market preference.

Bestellangaben: Rolle Typ; D; d2/d1; RL; Kugellager; SW, z. B.: Rolle Typ ML 108; 25/20; 1150 – 6204/15. Die Angabe d2 ist nur erforderlich, wenn d2 > als d1 sein muß.
Order details: Roller type; D; d2/d1; RL; ball bearing; SW, e.g.: Roller type ML 108; 25/20; 1150 – 6204/15. Detail d2 is only necessary when d2 must be > than d1.

| | | | |
|---|---|----------------------------------|-------------|
| STÜTZRINGANORDNUNG RUBBER DISC ARRANGEMENT |  | UNTERGURT RETURN BELT | 1000 |
|---|---|----------------------------------|-------------|

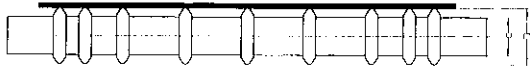

- ohne Zwischenhülsen
- without spacer sleeves
- mit Zwischenhülsen und Sicherungsringen
- with spacer sleeves and locking rings

Bitte bei der Anfrage/Bestellung angeben.
Please declare for request/order.

| | | Anordnung Form I Arrangement form I | | | |
|------|-----|--|--|---|---|
| d | D | Ringanzahl No. of rings | | ohne Hülsen without sleeves | mit Hülsen with sleeves |
| | | | | Bestück.- masse kg Equip.- mass kg | Bestück.- masse kg Equip.- mass kg |
| 63,5 | 108 | 9 | | 1,0 | 1,4 |
| 89 | 133 | 9 | | 2,5 | 3,6 |
| 108 | 159 | 9 | | 2,9 | 4,2 |
| 108 | 180 | 9 | | 5,2 | 6,5 |

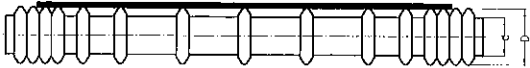

- ohne Zwischenhülsen
- without spacer sleeves
- mit Zwischenhülsen und Sicherungsringen
- with spacer sleeves and locking rings

Bitte bei der Anfrage/Bestellung angeben.
Please declare for request/order.

| | | Anordnung Form II Arrangement form II | | | |
|------|-----|--|--------------------|---|---|
| d | D | Ringanzahl No. of rings | | ohne Hülsen without sleeves | mit Hülsen with sleeves |
| | | Paket Packet | Gesamt Complete | Bestück.- masse kg Equip.- mass kg | Bestück.- masse kg Equip.- mass kg |
| | | | | | |
| 63,5 | 108 | 4 | 15 | 1,7 | 2,1 |
| 89 | 133 | 4 | 15 | 4,2 | 5,3 |
| 108 | 159 | 4 | 15 | 4,8 | 6,0 |
| 108 | 180 | 4 | 15 | 8,7 | 9,8 |

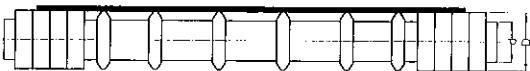

- ohne Zwischenhülsen
- without spacer sleeves
- mit Zwischenhülsen und Sicherungsringen
- with spacer sleeves and locking rings

Bitte bei der Anfrage/Bestellung angeben.
Please declare for request/order.

| | | Anordnung Form III Arrangement form III | | | |
|------|-----|--|---|---|---|
| d | D | Ringanzahl No. of rings | | ohne Hülsen without sleeves | mit Hülsen with sleeves |
| | | B | A | Bestück.- masse kg Equip.- mass kg | Bestück.- masse kg Equip.- mass kg |
| | | | | | |
| 63,5 | 108 | 8 | 6 | 3,0 | 3,4 |
| 89 | 133 | 8 | 6 | 4,5 | 5,5 |
| 108 | 159 | 8 | 6 | 7,0 | 8,1 |
| 108 | 180 | 8 | 6 | 10,8 | 11,9 |

Andere Anordnungen auf Anfrage / Other arrangements on request
Grundrolle siehe Blatt Nr. 2.06.09 / Basic roller refer to Sheet No. 2.06.09

Bestellangaben: Stützringanordnung, Gurtbreite, Form, D, Grundrolle mit/ohne Hülsen,
z. B.: Stützringanordnung, 1000, I, 108, SE 63,5 x 1150, o. Hülsen
Order details: Rubber disc arrangement, Belt width, form D, basic roller, with/without spacer sleeves,
e.g.: rubber disc arrangement 1000, I, 108 SE 63,5 x 1150, without sleeves

| | | | |
|------------------------------------|---|---|--------------------|
| <p>STATIONEN FRAMES</p> |  | <p>UNTERGURT RETURN BELT</p> | <p>1000</p> |
|------------------------------------|---|---|--------------------|

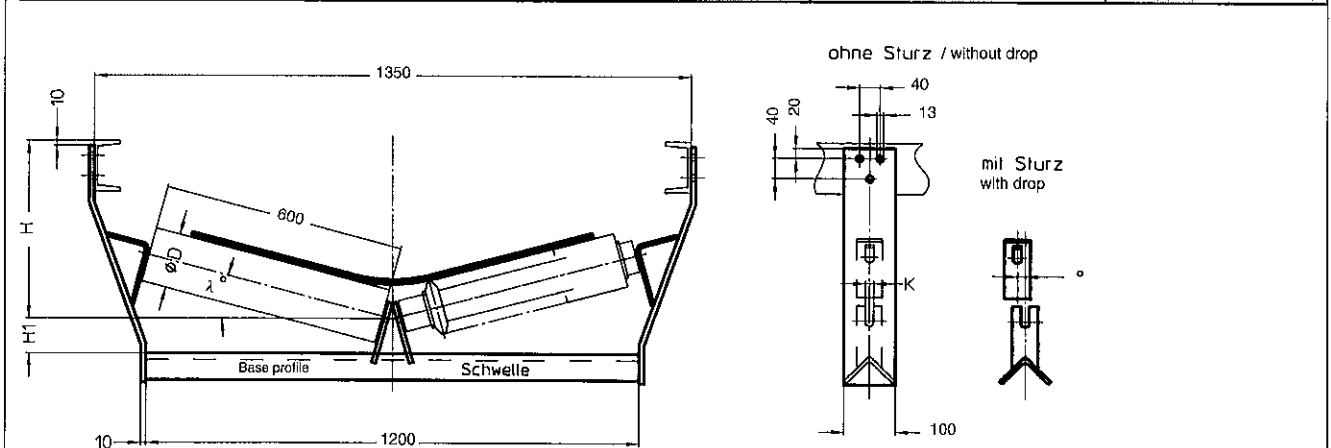

| Klinkung K Slot K | SW** | Achs ø Shaft ø |
|----------------------|------|-------------------|
| 15 | 14 | 20 |
| 16 | 15 | 20 |
| 19 | 18 | 25 |
| 23 | 22 | 30 |
| 31* | 30 | 20 |

* Aufsteckkappen / Adaptor caps
 ** Schlüsselweite / width across flat

| Schwelle Base profile | D | H 10° | H 15° | H1 | Masse in kg o. Rollen Mass in kg without roller | |
|--------------------------|----------|----------|----------|-----|--|-------|
| | | | | | λ 10° | λ 15° |
| ↘ 70 x 70 x 7 | 89 | 310 | 370 | 60 | 17,7 | 18,2 |
| | 108 | 320 | 380 | 70 | 18,2 | 18,7 |
| | 133 | 335 | 395 | 80 | 18,7 | 19,2 |
| | 159 | 350 | 410 | 90 | 19,0 | 19,5 |
| ↘ 70 x 70 x 7 | 108/63,5 | 320 | 380 | 70 | 18,7 | 19,2 |
| | 133/89 | 335 | 395 | 80 | | |
| | 159/108 | 350 | 410 | 90 | | |
| | 180/108 | 360 | 420 | 110 | | |

Blank space for additional information or notes.

Bestellangaben: 2-tlg. UB-Station. GB-1000, λ 10°, K = 16 für Ro. ø 89 mm, Schwelle ↘ 70 x 7, Rollen siehe Blatt Nr. 2.05.12
 Befestigungsmaterial siehe Kapitel Zubehör
Order details: 2-part UB-frame, BW-1000, λ 10°, K = 16, for Ro. Dia. 89 mm, base profile ↘ 70 x 7, Rollers refer to Sheet No. 2.05.12
 Fastening material, refer to chapter Accessories

| | | | |
|---------------------------|---|----------------------------------|-------------|
| ROLLEN ROLLERS |  | UNTERGURT RETURN BELT | 1000 |
|---------------------------|---|----------------------------------|-------------|

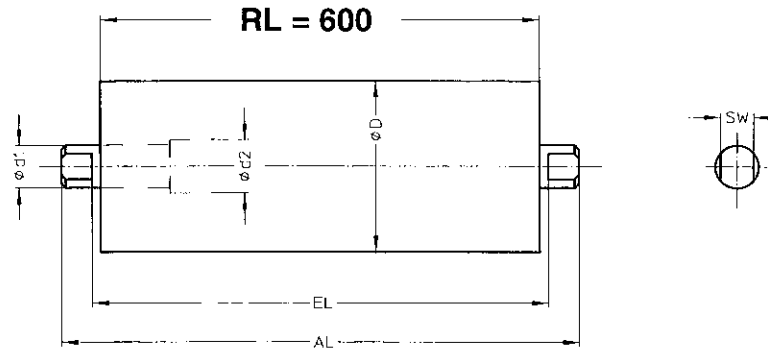

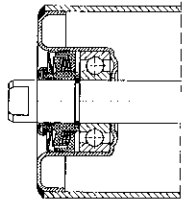
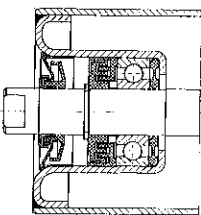
| Rollentyp Roller type | D | Achsdurchmesser d1 / Shaft diameter Kugellager / Ball bearings | | | | | | | | | |
|---|------|---|---------------------------------|--------------|---------------------------------|--------------|---------------------------------|--------------|---------------------------------|--------------|---------------------------------|
| | | 20 6204 | | 25 6205 | | 25 6305 | | 30 6206 | | 30 6306 | |
| | | Masse in kg / Mass in kg | | | | | | | | | |
| | | kpl. cpl. | dreh. Teile rot. parts | kpl. cpl. | dreh. Teile rot. parts | kpl. cpl. | dreh. Teile rot. parts | kpl. cpl. | dreh. Teile rot. parts | kpl. cpl. | dreh. Teile rot. parts |
| SE  | 63,5 | 3,7 | 2,1 | | | | | | | | |
| | 89 | 5,6 | 4,0 | | | | | | | | |
| | 108 | 6,5 | 4,9 | | | | | | | | |
| | 133 | 9,6 | 7,8 | | | | | | | | |
| ML  | 63,5 | 4,8 | 3,1 | 6,0 | 3,4 | | | | | | |
| | 89 | 6,1 | 4,3 | 6,9 | 4,4 | 7,2 | 4,6 | 8,2 | 4,5 | 11,8 | 8,0 |
| | 108 | 8,0 | 6,3 | 8,6 | 6,0 | 8,9 | 6,2 | 9,8 | 6,2 | 10,7 | 6,9 |
| | 133 | 11,1 | 9,4 | 11,7 | 9,1 | 12,2 | 9,5 | 13,1 | 9,5 | 13,9 | 10,1 |
| | 159 | | | 14,9 | 12,3 | 15,1 | 12,5 | 16,1 | 12,4 | 16,6 | 12,8 |

| Anschlußmaße / Connecting dimensions | | | | | | |
|--------------------------------------|--|-----|-----|--|-----|-----|
| d1 | Achsenden A2 nach DIN 15207 von 1960 Shaft ends A2 to DIN 15207 dtd. 1960 | | | Achsenden A2 nach DIN 15207 von 1988 Shaft ends A2 to DIN 15207 dtd. 1988 | | |
| | SW | EL | AL | SW | EL | AL |
| 20 | 15* | 606 | 632 | 14 | 608 | 632 |
| 25 | | | | 18 | 608 | 632 |
| 30 | | | | 22 | 608 | 632 |

* Bei Rollen mit Achsdurchmesser 20 mm empfehlen wir die vom Markt bevorzugte Ausführung mit SW 15. / For rollers with the shaft diameter 20 mm we recoment the design with presently enjoys market preference.

Bestellangaben: Rolle Typ; D; d2/d1; RL; Kugellager; SW, z. B.: Rolle ML 108; 20; 600 – 6204/15. Die Angabe d2 ist nur erforderlich, wenn d2 > als d1 sein muß.
Order details: Roller type; D; d2/d1; RL; ball bearing; SW, e.g.: Roller ML 108; 20; 600 – 6204/15. Detail d2 is only necessary when d2 must be > than d1.

**STÜTZRINGANORDNUNG
RUBBER DISC ARRANGEMENT**



**UNTERGURT
RETURN BELT**

1000

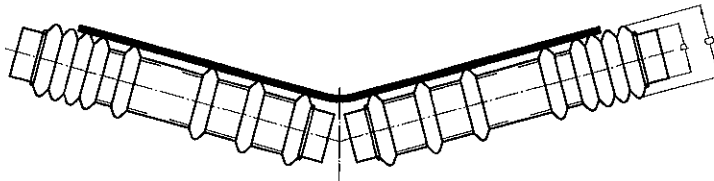

mit Zwischenhülsen und Sicherungsringen
with spacer sleeves and locking rings

| | | Anordnung Form IV Arrangement form IV | | |
|------|-----|--|--------------------|---|
| d | D | Ringanzahl No. of rings | | Bestück.- masse kg Equip.- mass kg |
| | | Paket Packet | Gesamt Complete | |
| 63,5 | 108 | 4 | 8 | 1,1 |
| 89 | 133 | 4 | 8 | 2,7 |
| 108 | 159 | 4 | 8 | 3,3 |
| 108 | 180 | 4 | 8 | 5,3 |

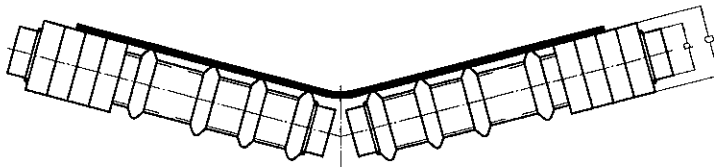

mit Zwischenhülsen und Sicherungsringen
with spacer sleeves and locking rings

| | | Anordnung Form V Arrangement form V | | |
|------|-----|--|---|---|
| d | D | Ringanzahl No. of rings | | Bestück.- masse kg Equip.- mass kg |
| | | B | A | |
| 63,5 | 108 | 4 | 4 | 1,8 |
| 89 | 133 | 4 | 4 | 2,9 |
| 108 | 159 | 4 | 3 | 4,2 |
| 108 | 180 | 4 | 3 | 6,1 |

Andere Anordnungen auf Anfrage / Other arrangements on request
Grundrolle siehe Blatt Nr. 2.05.12 / Basic roller refer to Sheet No. 2.05.12

Bestellangaben: Stützringanordnung, Gurtbreite, Form, D, Grundrolle, z. B.: Stützringanordnung, 1000, V, 133, SE 89 x 600
Order details: Rubber disc arrangement, Belt width, form, D, basic roller, e.g.: rubber disc arrangement 1000, V, 133 SE 89 x 600

| | | | |
|--------------------------------------|---|----------------------------------|-------------|
| DACHSTATIONEN ROOF FRAMES |  | UNTERGURT RETURN BELT | 1000 |
|--------------------------------------|---|----------------------------------|-------------|

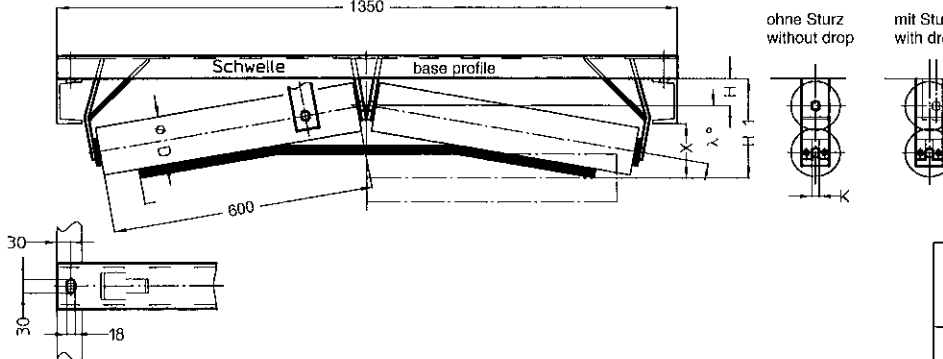

| Klinkung K Slot K | SW* | Achs ø Shaft ø |
|----------------------|-----|-------------------|
| 15 | 14 | 20 |
| 16 | 15 | 20 |
| 19 | 18 | 25 |
| 23 | 22 | 30 |

* Schlüsselweite /
width across flat

| Schwelle Base profile | D | H | X | H1 | Masse in kg o. Rollen bei Mass in kg without rollers at | |
|---------------------------------------|-----|----|-----|-----|--|---------------|
| | | | | | λ 10° | λ 15° |
| U 100 Warmgewalzt U 100 hot-rolled | 89 | 50 | 70 | 170 | 16,1 | 16,7 |
| | 108 | 60 | 70 | 170 | 16,5 | 17,1 |
| | 133 | 70 | 100 | 200 | 16,9 | 17,5 |
| U 120 Warmgewalzt U 120 hot-rolled | 89 | 50 | 70 | 170 | 20,0 | 20,6 |
| | 108 | 60 | 70 | 170 | 20,4 | 21,0 |
| | 133 | 70 | 100 | 200 | 20,8 | 21,4 |
| | 159 | 70 | 100 | 220 | 22,0 | 22,6 |

Bestellangaben: 2-tlg. Dachstation. GB-1000, λ 10°, K = 16 für Ro. ø 89 mm, Schwelle U 100, Rollen siehe Blatt Nr. 2.05.12
Befestigungsmaterial siehe Kapitel Zubehör

Order details: 2-part roof frame, BW-1000, λ 10°, K = 16, for Ro. Dia. 89 mm, base profile U 100, Rollers refer to Sheet No. 2.05.12
Fastening material, refer to chapter Accessories

**Gurtbreite 1000 mm
Belt width 1000 mm**

Girlanden

Garlands

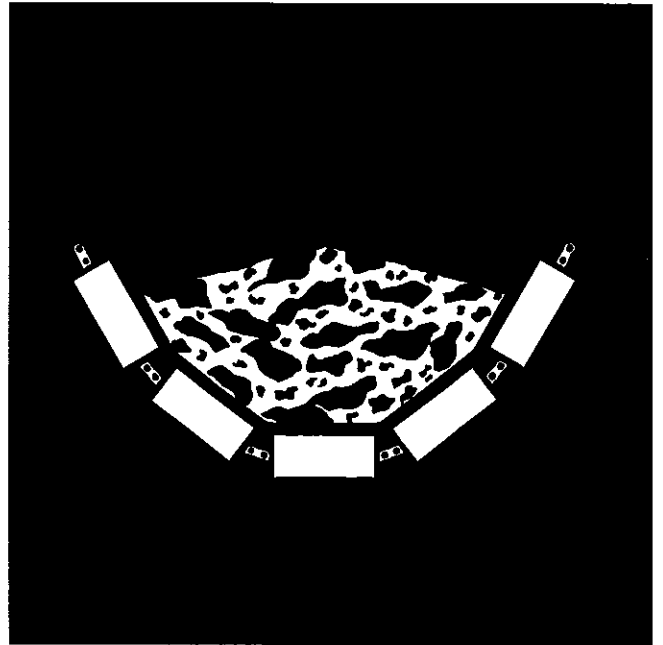

Inhalt Girlanden Gurtbreite 1000 mm

Content garlands belt width 1000 mm

Blatt / Sheet

| Auswahltabelle für Girlanden | | Blatt / Sheet | Selectiontable for Garlands | |
|------------------------------------|--------------------|----------------|-------------------------------------|----------------------|
| Girlandenrollen | 3-teilig Obergurt | 2.05.0 | Garland rollers | 3-part carrying belt |
| Girlandenpolsterrollen | 3-teilig Obergurt | 2.05.15 | Impact garland rollers | 3-part carrying belt |
| Girlandenrollen | 5-teilig Obergurt | 2.05.16 | Garland rollers | 5-part carrying belt |
| Girlandenrollen | 2-teilig Untergurt | 2.05.21 | Garland rollers | 2-part return belt |
| Girlanden- Stützringanordnungen | 2-teilig Untergurt | 2.05.22 | Garland rubber disc arrangements | 2 part return belt |
| | | 2.05.23 | | |

Maßgrundlagen für Girlandenrollen

Dimension basics for garland rollers

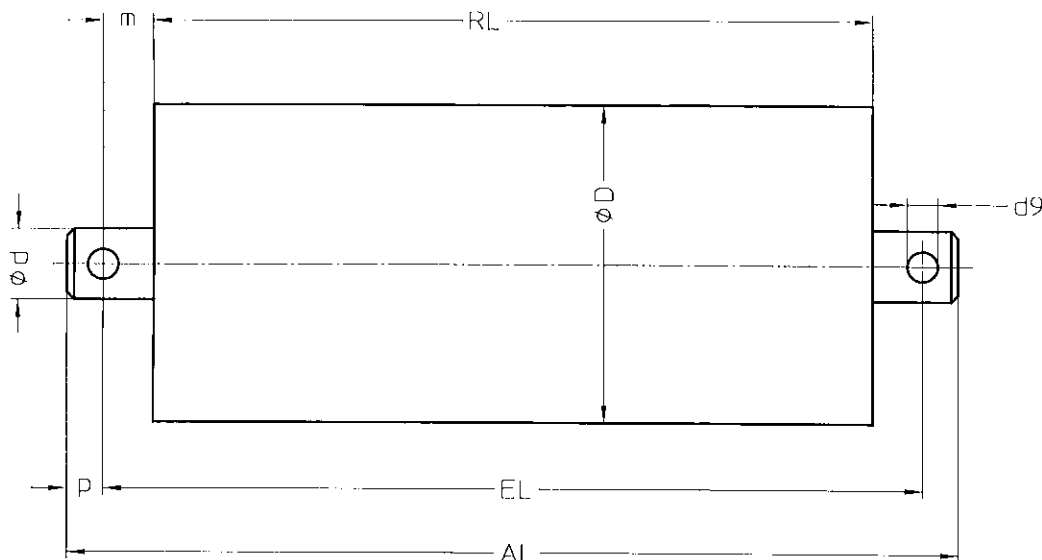

| Kugellager Ball bearing | Achs \varnothing d [mm] Shaft \varnothing d [mm] | Verbindungsglied* connection element | d9 | m | p |
|----------------------------|---|---|------|----|----|
| 6204 | 20 | VG 8-25 VG 8-32 | 8.5 | 14 | 10 |
| 6205/6305 | 25 | VG 10-32 VG 10-38 | 10.5 | 16 | 12 |
| 6206/6306 | 30 | VG 12-38 VG 12-44 | 12.5 | 20 | 15 |

* Verbindungsglieder siehe Kapitel 3, Blatt Nr. 3.00.18 / Connection element refer to chapter 3, Sheet No. 3.00.18

Auswahltabelle für Girlanden
Gurtbreite 1000 mm

Selectiontable for garlands
Belt width 1000 mm

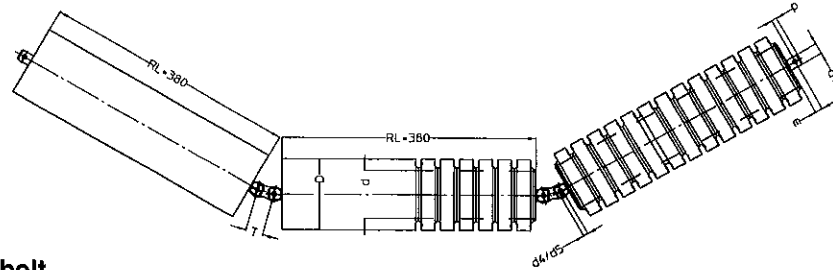

Obergurt / Carrying belt

| Rollentyp Roller type | Rollen ø Roller ø | Polsterrollen Rubber ring ø | Achs ø Shaft ø | Teilung Division | Bolzen ø Bolts ø | Schrauben ø Screws ø | Abstand Distance | Muldung bis Trouthing up to | Verbindungs- glied Intercon- element VG | Aufhängung Form Suspension design |
|--------------------------|----------------------|---|-------------------|---------------------|---------------------|-------------------------|---------------------|-----------------------------------|---|--|
| | D | d/D | d1 | T | d5 | d4 | m/p | | | |
| SE/ML | 89/108/(133) | 63,5/89 + 63,5/108 + 89/133 + 89/159 + 108/159 + 108/180 | 20 | 25,40 | 8,27 | M 8 | 14/10 | 45° (35°) | VG 8-25 | 1 + 2 + 3 + 5 + 9 |
| SE/ML | 89/108/133 | 63,5/89 + 63,5/108 + 89/133 + 89/159 + 108/159 + 108/180 | 20 | 31,75 | 8,27 | M 8 | 14/10 | 45° | VG 8-32 | 1 bis 5+9 |
| ML | 89/108/133/(159) | 63,5/89 + 63,5/108 + 89/133 + 89/159 + 108/159 + 108/180 | 25 | 31,75 | 10,17 | M 10 | 16/12 | 45° (35°) | VG 10-32 | 1 + 2 + 3 + 5 |
| ML | 89/108/133/159 | 63,5/89 + 63,5/108 + 89/133 + 89/159 + 108/159 + 108/180 | 25 | 38,10 | 10,17 | M 10 | 16/12 | 45° | VG 10-38 | 1 bis 5 |
| ML | 89/108/133/159 | 89/133 + 89/159 + 108/159 + 108/180 | 30 | 38,10 | 11,95 | M 12 | 20/15 | 45° | VG 12-38 | 1+2+3+5+6+8 |
| ML | 89/108/133/159 | 89/133 + 89/159 + 108/159 108/180 | 30 | 44,45 | 11,95 | M 12 | 20/15 | 45° | VG 12-44 | 1 bis 6 + 8 |

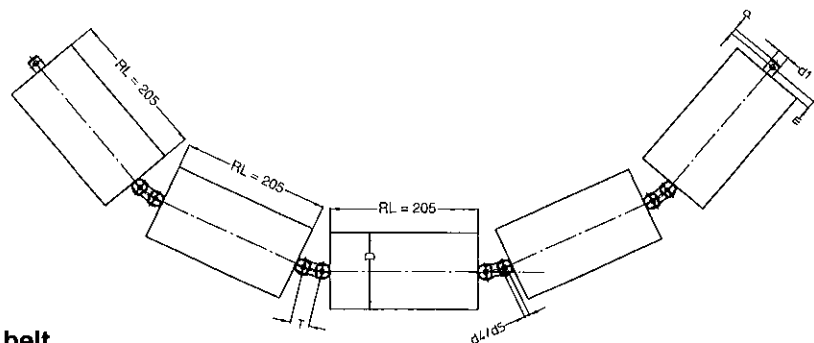

Obergurt / Carrying belt

| Rollentyp Roller type | Rollen ø Roller ø | | Achs ø Shaft ø | Teilung Division | Bolzen ø Bolts ø | Schrauben ø Screws ø | Abstand Distance | Muldung bis Trouthing up to | Verbindungs- glied Intercon- element VG | Aufhängung Form Suspension design |
|--------------------------|----------------------|--|-------------------|---------------------|---------------------|-------------------------|---------------------|-----------------------------------|---|--|
| | D | | d1 | T | d5 | d4 | m/p | | | |
| SE/ML | 89/108/133 | | 20 | 25,40 | 8,27 | M 8 | 14/10 | 60° | VG 8-25 | 1 + 2 + 3 + 5 + 9 |
| SE/ML | 89/108/133 | | 20 | 31,75 | 8,27 | M 8 | 14/10 | 60° | VG 8-32 | 1 bis 5+9 |
| ML | 89/108/133/159 | | 25 | 31,75 | 10,17 | M 10 | 16/12 | 60° | VG 10-32 | 1 + 2 + 3 + 5 |
| ML | 89/108/133/159 | | 25 | 38,10 | 10,17 | M 10 | 16/12 | 60° | VG 10-38 | 1 bis 5 |
| ML | 89/108/133/159 | | 30 | 38,10 | 11,95 | M 12 | 20/15 | 60° | VG 12-38 | 1+2+3+5+6+8 |
| ML | 89/108/133/159 | | 30 | 44,45 | 11,95 | M 12 | 20/15 | 60° | VG 12-44 | 1 bis 6 + 8 |

Auswahltabelle für Girlanden Gurtbreite 1000 mm

Selectiontable for garlands Belt width 1000 mm

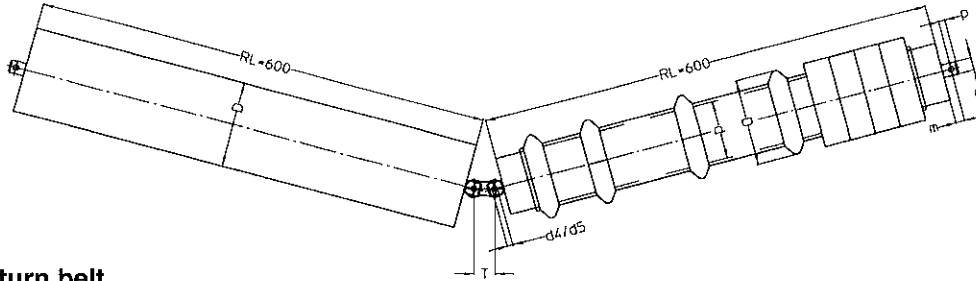

Untergurt / Return belt

| Rollen typ | Rollen \varnothing | Stützringrollen \varnothing | Achs \varnothing | Teilung | Bolzen \varnothing | Schrauben \varnothing | Abstand | Muldung bis Troughing up to | Verbindungs-glied Intercon. element VG | Aufhängung Form Suspension design |
|-------------|----------------------|---------------------------------------|---------------------|----------|----------------------|-------------------------|----------|-----------------------------|--|-----------------------------------|
| Roller type | Roller \varnothing | Impact ring \varnothing | Shaft \varnothing | Division | Bolts \varnothing | Screws \varnothing | Distance | | | |
| | D | d/D | d1 | T | d5 | d4 | m/p | | | |
| SE/ML | 63,5/89/108/133 | 63,5/108 + 89/133 + 108/159 + 108/180 | 20 | 25,40 | 8,27 | M 8 | 14/10 | 15° | VG 8-25 | 1 + 2 + 3 + 5 + 9 |
| SE/ML | 63,5/89/108/133 | 63,5/108 + 89/133 + 108/159 + 108/180 | 20 | 31,75 | 8,27 | M 8 | 14/10 | 15° | VG 8-32 | 1 bis 5+9 |
| ML | 63,5/89/108/133/159 | 63,5/108 + 89/133 + 108/159 + 108/180 | 25 | 31,75 | 10,17 | M 10 | 16/12 | 15° | VG 10-32 | 1 + 2 + 3 + 5 |
| ML | 63,5/89/108/133/159 | 63,5/108 + 89/133 + 108/159 + 108/180 | 25 | 38,10 | 10,17 | M 10 | 16/12 | 15° | VG 10-38 | 1 bis 5 |
| ML | 89/108/133/159 | 89/133 + 108/159 + 108/180 | 30 | 38,10 | 11,95 | M 12 | 20/15 | 15° | VG 12-38 | 1 + 2 + 3 + 5 + 6 |
| ML | 89/108/133/159 | 89/133 + 108/159 + 108/180 | 30 | 44,45 | 11,95 | M 12 | 20/15 | 15° | VG 12-44 | 1 bis 6 |

| | | | |
|--|---|-----------------------------------|-------------|
| GIRLANDENROLLEN GARLAND ROLLERS |  | OBERGURT CARRYING BELT | 1000 |
|--|---|-----------------------------------|-------------|

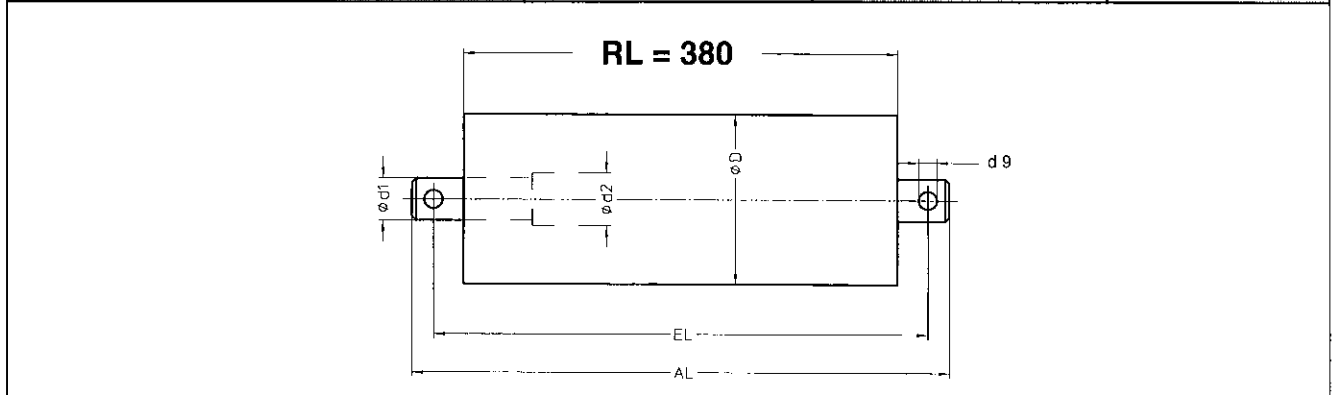

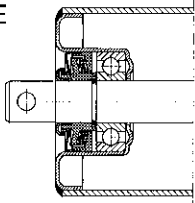
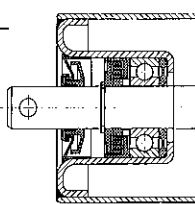
| Rollentyp Roller type | D | Achsdurchmesser d1 / Shaft diameter Kugellager / Ball bearings | | | | | | | | | |
|---|-----|---|---------------------------------|--------------|---------------------------------|--------------|---------------------------------|--------------|---------------------------------|--------------|---------------------------------|
| | | 20 6204 | | 25 6205 | | 25 6305 | | 30 6206 | | 30 6306 | |
| | | Masse in kg / Mass in kg | | | | | | | | | |
| | | kpl. cpl. | dreh. Teile rot. parts | kpl. cpl. | dreh. Teile rot. parts | kpl. cpl. | dreh. Teile rot. parts | kpl. cpl. | dreh. Teile rot. parts | kpl. cpl. | dreh. Teile rot. parts |
| SE  | 89 | 3,8 | 2,7 | | | | | | | | |
| | 108 | 4,5 | 3,4 | | | | | | | | |
| | 133 | 6,6 | 5,3 | | | | | | | | |
| ML  | 89 | 4,2 | 3,1 | 4,9 | 3,1 | 5,1 | 3,3 | 5,7 | 3,2 | 8,3 | 5,7 |
| | 108 | 5,7 | 4,5 | 5,9 | 4,2 | 6,2 | 4,4 | 6,8 | 4,3 | 7,6 | 5,1 |
| | 133 | 7,8 | 6,6 | 8,0 | 6,3 | 8,5 | 6,7 | 9,1 | 6,6 | 9,8 | 7,2 |
| | 159 | | | 10,4 | 8,6 | 10,5 | 8,8 | 11,1 | 8,7 | 11,6 | 9,1 |

| Anschlußmaße / Connecting dimensions | | | |
|--|------|-----|-----|
| Achsenden nach DIN 15207 von 1988 Shaft ends to DIN 15207 dtd. 1988 | | | |
| d1 | d9 | EL | AL |
| 20 | 8,5 | 408 | 428 |
| 25 | 10,5 | 412 | 436 |
| 30 | 12,5 | 420 | 450 |

Girlandenzubehör siehe Kapitel 3 / Garland accessories refer to chapter 3

Bestellangaben: Girlandenrolle Typ; D; d2/d1; RL; Kugellager; Achsende d9, z. B.: Girlandenrolle ML 133; 20; 380 – 6204, – 8,5. Die Angabe d2 ist nur erforderlich, wenn d2 > als d1 sein muß.
Order details: Garland roller type; D; d2/d1; RL; ball bearing; shaft end d9, e.g.: Garland roller ML 133; 20; 380 – 6204, – 8,5. Detail d2 is only necessary when d2 must be > than d1.

| | | | |
|--|---|---|-------------|
| GIRLANDENPOLSTERROLLEN IMPACT GARLAND ROLLERS |  | OBERGURT CARRYING BELT | 1000 |
|--|---|---|-------------|

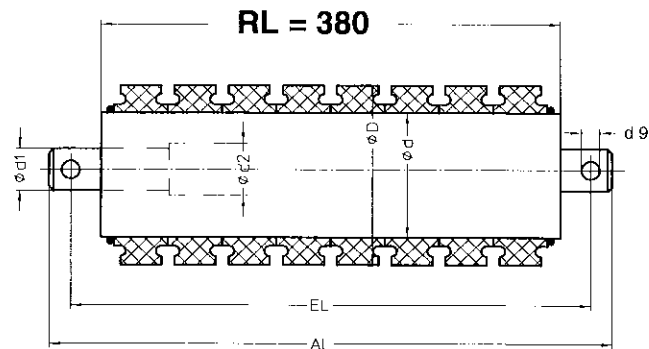

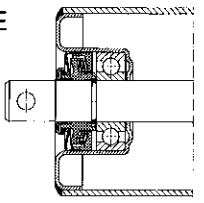
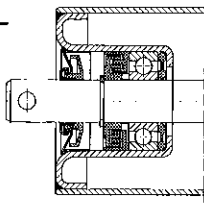
| Rollentyp Roller type | d | D | Achsdurchmesser d1 / Shaft diameter Kugellager / Ball bearings | | | | | | | | | | |
|--|------|-----|---|---------------------------------|--------------|---------------------------------|--------------|---------------------------------|--------------|---------------------------------|--------------|---------------------------------|--|
| | | | 20 6204 | | 25 6205 | | 25 6305 | | 30 6206 | | 30 6306 | | |
| | | | Masse in kg / Mass in kg | | | | | | | | | | |
| | | | kpl. cpl. | dreh. Teile rot. parts | kpl. cpl. | dreh. Teile rot. parts | kpl. cpl. | dreh. Teile rot. parts | kpl. cpl. | dreh. Teile rot. parts | kpl. cpl. | dreh. Teile rot. parts | |
| SE  | 63,5 | 89 | 4,0 | 2,9 | | | | | | | | | |
| | 63,5 | 108 | 4,6 | 3,5 | | | | | | | | | |
| | 89 | 133 | 6,5 | 5,4 | | | | | | | | | |
| | 89 | 159 | 7,8 | 6,7 | | | | | | | | | |
| | 108 | 159 | 8,5 | 7,4 | | | | | | | | | |
| | 108 | 180 | 10,2 | 9,1 | | | | | | | | | |
| ML  | 63,5 | 89 | 4,7 | 3,5 | 5,6 | 3,9 | | | | | | | |
| | 63,5 | 108 | 5,3 | 4,1 | 6,2 | 4,5 | | | | | | | |
| | 89 | 133 | 6,9 | 5,8 | 7,5 | 5,8 | 7,8 | 6,0 | 8,4 | 5,9 | 11,0 | 8,4 | |
| | 89 | 159 | 8,2 | 7,1 | 8,8 | 7,1 | 9,1 | 7,3 | 9,7 | 7,2 | 12,3 | 9,7 | |
| | 108 | 159 | 9,6 | 8,5 | 9,9 | 8,2 | 10,2 | 8,4 | 10,8 | 8,3 | 11,6 | 9,0 | |
| | 108 | 180 | 11,3 | 10,2 | 11,6 | 9,9 | 11,9 | 10,1 | 12,5 | 10,0 | 13,3 | 10,7 | |

| Anschlußmaße / Connecting dimensions | | | |
|--|------|-----|-----|
| Achsende nach DIN 15207 von 1988 Shaft end to DIN 15207 dtd. 1988 | | | |
| d1 | d9 | EL | AL |
| 20 | 8,5 | 408 | 428 |
| 25 | 10,5 | 412 | 436 |
| 30 | 12,5 | 420 | 450 |

Girlandenzubehör siehe Kapitel 3 / Garland accessories refer to chapter 3

Bestellangaben: Girlanden-Polsterrolle Typ; D/d; d2/d1; RL; Kugellager; Achsende – d9, z. B.: Girlanden-Polsterrolle ML 133/89; 20; 380 – 6204, – 8,5. Die Angabe d2 ist nur erforderlich, wenn d2 > als d1 sein muß.
Order details: Impact garland roller type; D/d; d2/d1; RL; ball bearing; shaft end d9, e.g.: Impact garland roller ML 133/89; 20; 380 – 6204, – 8,5. Detail d2 is only necessary when d2 must be > than d1.

| | | | |
|--|---|-----------------------------------|-------------|
| GIRLANDENROLLEN GARLAND ROLLERS |  | OBERGURT CARRYING BELT | 1000 |
|--|---|-----------------------------------|-------------|

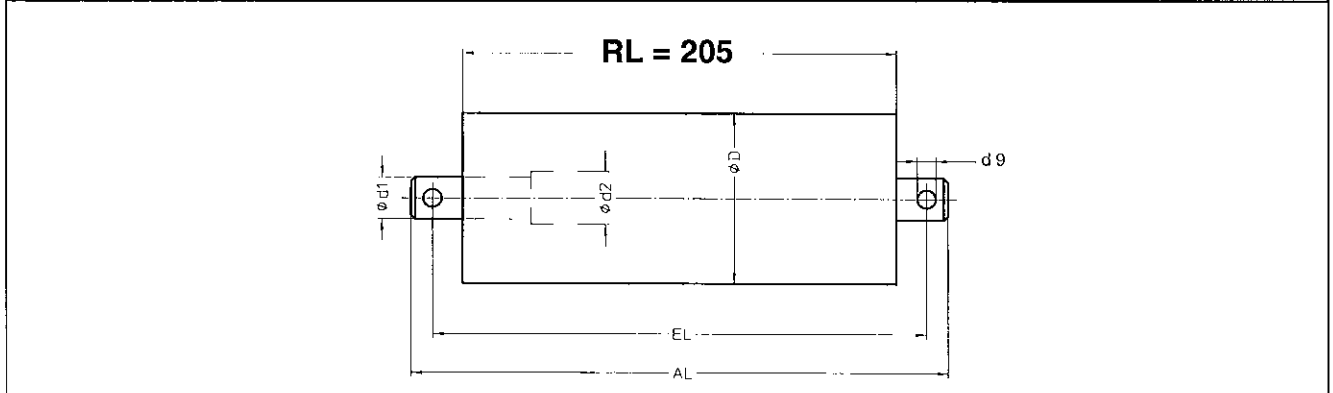

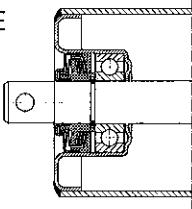
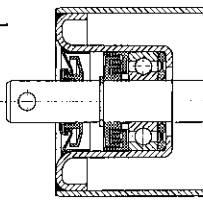
| Rollentyp Roller type | D | Achsdurchmesser d1 / Shaft diameter Kugellager / Ball bearings | | | | | | | | | |
|--|-----|---|---------------------------------|--------------|---------------------------------|--------------|---------------------------------|--------------|---------------------------------|--------------|---------------------------------|
| | | 20 6204 | | 25 6205 | | 25 6305 | | 30 6206 | | 30 6306 | |
| | | Masse in kg / Mass in kg | | | | | | | | | |
| | | kpl. cpl. | dreh. Teile rot. parts | kpl. cpl. | dreh. Teile rot. parts | kpl. cpl. | dreh. Teile rot. parts | kpl. cpl. | dreh. Teile rot. parts | kpl. cpl. | dreh. Teile rot. parts |
| SE  | 89 | 2,3 | 1,7 | | | | | | | | |
| | 108 | 2,8 | 2,1 | | | | | | | | |
| | 133 | 4,0 | 3,3 | | | | | | | | |
| ML  | 89 | 2,7 | 2,1 | 3,1 | 2,1 | 3,4 | 2,3 | 3,7 | 2,2 | 5,5 | 3,9 |
| | 108 | 3,7 | 3,0 | 3,8 | 2,7 | 4,1 | 3,0 | 4,3 | 2,9 | 5,2 | 3,6 |
| | 133 | 5,0 | 4,3 | 5,1 | 4,0 | 5,6 | 4,5 | 5,9 | 4,4 | 6,6 | 5,0 |
| | 159 | | | 6,7 | 5,7 | 6,9 | 5,8 | 7,2 | 5,7 | 7,7 | 6,1 |

| Anschlußmaße / Connecting dimensions | | | |
|--|------|-----|-----|
| Achsende nach DIN 15207 von 1988 Shaft end to DIN 15207 dtd. 1988 | | | |
| d1 | d9 | EL | AL |
| 20 | 8,5 | 233 | 253 |
| 25 | 10,5 | 237 | 261 |
| 30 | 12,5 | 245 | 275 |

Girlandenzubehör siehe Kapitel 3 / Garland accessories refer to chapter 3

Bestellangaben: Girlandenrolle Typ; D; d2/d1; RL; Kugellager; Achsende d9, z. B.: Girlandenrolle ML 133; 20; 205 – 6204 – 8,5. Die Angabe d2 ist nur erforderlich, wenn d2 > als d1 sein muß.
Order details: Garland roller type; D; d2/d1; RL; ball bearing; shaft end d9, e.g.: Garland roller ML 133; 20; 205 – 6204 – 8,5. Detail d2 is only necessary when d2 must be > than d1.

| | | | |
|--|---|----------------------------------|-------------|
| GIRLANDENROLLEN GARLAND ROLLERS |  | UNTERGURT RETURN BELT | 1000 |
|--|---|----------------------------------|-------------|

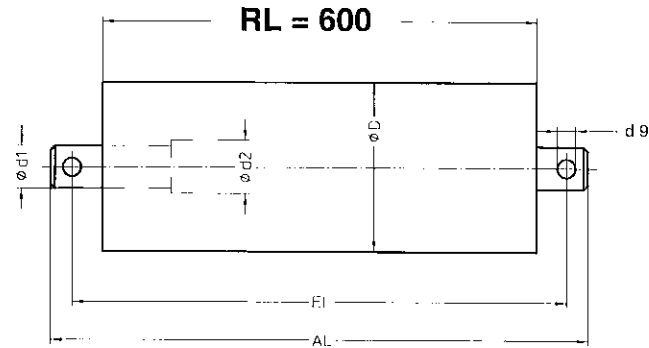

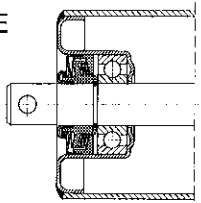
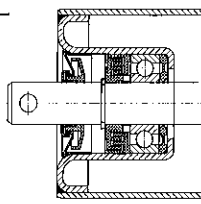
| Rollentyp Roller type | D | Achsdurchmesser d1 / Shaft diameter Kugellager / Ball bearings | | | | | | | | | |
|--|------|---|---------------------------------|--------------|---------------------------------|--------------|---------------------------------|--------------|---------------------------------|--------------|---------------------------------|
| | | 20 6204 | | 25 6205 | | 25 6305 | | 30 6206 | | 30 6306 | |
| | | Masse in kg / Mass in kg | | | | | | | | | |
| | | kpl. cpl. | dreh. Teile rot. parts | kpl. cpl. | dreh. Teile rot. parts | kpl. cpl. | dreh. Teile rot. parts | kpl. cpl. | dreh. Teile rot. parts | kpl. cpl. | dreh. Teile rot. parts |
| SE  | 63,5 | 3,7 | 2,1 | | | | | | | | |
| | 89 | 5,6 | 4,0 | | | | | | | | |
| | 108 | 6,5 | 4,9 | | | | | | | | |
| | 133 | 9,6 | 7,8 | | | | | | | | |
| ML  | 63,5 | 4,8 | 3,1 | 6,0 | 3,4 | | | | | | |
| | 89 | 6,1 | 4,3 | 6,9 | 4,4 | 7,2 | 4,6 | 8,2 | 4,5 | 11,8 | 8,0 |
| | 108 | 8,0 | 6,3 | 8,6 | 6,0 | 8,9 | 6,2 | 9,8 | 6,2 | 10,7 | 6,9 |
| | 133 | 11,1 | 9,4 | 11,7 | 9,1 | 12,2 | 9,5 | 13,1 | 9,5 | 13,9 | 10,1 |
| | 159 | | | 14,9 | 12,3 | 15,1 | 12,5 | 16,1 | 12,4 | 16,6 | 12,8 |

| Anschlußmaße / Connecting dimensions | | | |
|--|------|-----|-----|
| Achsende nach DIN 15207 von 1988 Shaft end to DIN 15207 dtd. 1988 | | | |
| d1 | d9 | EL | AL |
| 20 | 8,5 | 628 | 648 |
| 25 | 10,5 | 632 | 656 |
| 30 | 12,5 | 640 | 670 |

Girlandenzubehör siehe Kapitel 3 / Garland accessories refer to chapter 3

Bestellangaben: Girlandenrolle Typ; D; d2/d1; RL; Kugellager; Achsende d9, z. B.: Girlandenrolle ML 133; 20; 600 – 6204 – 8,5. Die Angabe d2 ist nur erforderlich, wenn d2 > als d1 sein muß.

Order details: Garland roller type; D; d2/d1; RL; ball bearing; shaft end d9, e.g.: Garland roller ML 133; 20; 600 – 6204 – 8,5. Detail d2 is only necessary when d2 must be > than d1.

**STÜTZRINGANORDNUNG
RUBBER DISC ARRANGEMENT**



**UNTERGURT
RETURN BELT**

1000

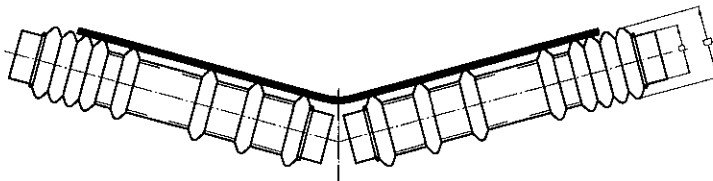

mit Zwischenhülsen und Sicherungsringen
with spacer sleeves and locking rings

Anordnung Form IV
Arrangement form IV

| d | D | Ringanzahl No. of rings | | Bestück- masse kg Equip- mass kg |
|------|-----|----------------------------|--------------------|---|
| | | Paket Packet | Gesamt Complete | |
| 63,5 | 108 | 4 | 8 | 1,1 |
| 89 | 133 | 4 | 8 | 2,7 |
| 108 | 159 | 4 | 8 | 3,3 |
| 108 | 180 | 4 | 8 | 5,3 |

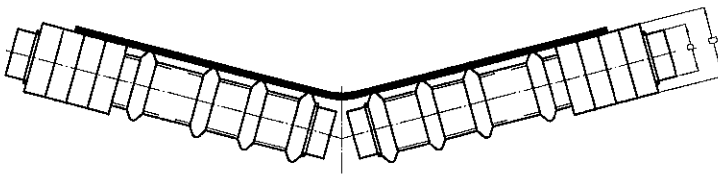

mit Zwischenhülsen und Sicherungsringen
with spacer sleeves and locking rings

Anordnung Form V
Arrangement form V

| d | D | Ringanzahl No. of rings | | Bestück- masse kg Equip- mass kg |
|------|-----|----------------------------|---|---|
| | | B | A | |
| 63,5 | 108 | 4 | 4 | 1,8 |
| 89 | 133 | 4 | 4 | 2,9 |
| 108 | 159 | 4 | 3 | 4,2 |
| 108 | 180 | 4 | 3 | 6,1 |

Andere Anordnungen auf Anfrage / Other arrangements on request
Grundrolle siehe Blatt Nr. 2.05.22 / Basic roller refer to Sheet No. 2.05.22

Bestellangaben: Stützringanordnung, Gurtbreite, Form, D, Grundrolle, z. B.: Stützringanordnung, 1000, V, 133, SE 89 x 600
Order details: Rubber disc arrangement, Belt width, form, D, basic roller, e.g.: rubber disc arrangement 1000, V, 133 SE 89 x 600

**Gurtbreite 1000 mm
Belt width 1000 mm**

Trommeln

Pulleys

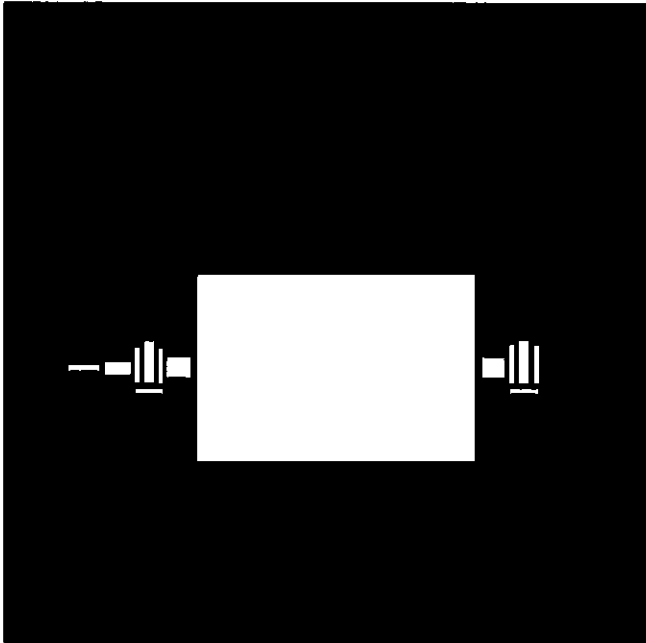

Inhalt Trommeln Gurtbreite 1000 mm

Contents pulleys belt width 1000 mm

Blatt / Sheet

| | | |
|---|----------------|---|
| Angetriebene Trommeln – außengelagert | | Driving pulleys – external bearings |
| Ausführung geschweißte Trommeln | 2.05.24 | Execution welded pulleys |
| Nichtangetriebene Trommeln – außengelagert | | Non-driving pulleys – external bearings |
| Ausführung geschweißte Trommeln | 2.05.25 | Execution welded pulleys |
| Angetriebene Trommeln – außengelagert | | Driving pulleys – external bearings |
| Ausführung mit Spannsätzen | 2.05.26 | Execution with locking devices |
| Nichtangetriebene Trommeln – außengelagert | | Non-driving pulleys – external bearings |
| Ausführung mit Spannsätzen | 2.05.27 | Execution with locking devices |
| Nicht angetriebene Trommeln – innengelagert | 2.05.28 | Non-driving pulleys – internal bearings |

**ANGETRIEBENE TROMMELN
AUSSENGELAGERT
DRIVING PULLEYS
EXTERNAL BEARINGS**



1000

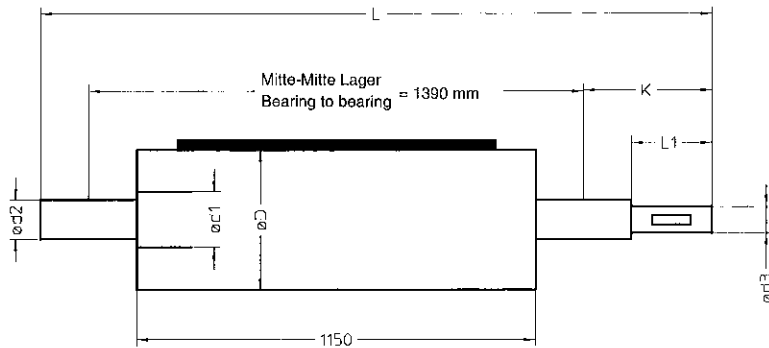

- Trommelmantel ballig
Pulley casing crowned
- Trommelmantel zylindrisch
Pulley casing cylindrical

Bei Anfragen/Bestellungen bitte angeben
Please declare for requests/orders

| Trommel ø Pulley ø D | Wellen ø / Shaft ø | | | L | K | L 1 | Masse in kg o. Belag Mass in kg without cover | Stehlager Typ SNL Pillow block Type SNL | Lagerreihe Bearing series |
|----------------------------|--------------------|-------------------------|-------------------------|------|-----|-----|--|--|------------------------------|
| | Nabe Hub d 1 | Lager Bearing d 2 | Antrieb Drive d 3 | | | | | | |
| 217 270 321 403 | 60 | 45 | 40 | 1541 | 125 | 70 | 95 104 130 164 | 510 | 22210/H3 |
| 217 270 321 403 | 75 | 50 | 45 | 1556 | 138 | 80 | 106 114 142 176 | 511 | 22211/H3 |
| 217 270 321 403 | 90 | 65 | 60 | 1592 | 168 | 100 | 136 162 196 230 | 515 | 22215/H3 |
| 270 321 403 | 100 | 80 | 75 | 1623 | 193 | 120 | 171 208 259 | 518 | 22218/H3 |
| 270 321 403 | 110 | 90 | 85 | 1658 | 223 | 140 | 192 211 279 | 520 | 22220/H3 |

1- geschweißte Ausführung / 1 - Welded design

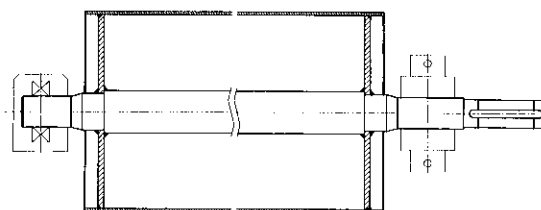

Trommelbeläge siehe Kapitel 1, Blatt-Nr. 1.00.41 / Pulley covers refer to chapter 1, Sheet No. 1.00.41

Bestellbeispiel: Trommelbezeichnung; GB; Tro.-Typ.; Tro.-ø; d1; d2; Gummibelag (Dicke; Oberfläche + SHORE „A“); mit oder ohne Stehlager; z. B.: AT, 1000; Typ 1, 403 mm ø, 75/50/45, 8 mm, ETR 70, mit SNL 511
Order example: Pulley designation: Belt width; pulley type; pulley ø; d1; d2; rubber cover (thickness, surface + SHORE "A"); with or without pillow block; e. g.: 1000; type 1; 403 mm ø, 75/50/45, 8 mm, ETR 70, with SNL 511

**NICHT ANGETRIEBENE
TROMMELN AUSSENGELAGERT
NON-DRIVING PULLEYS
EXTERNAL BEARINGS**



1000

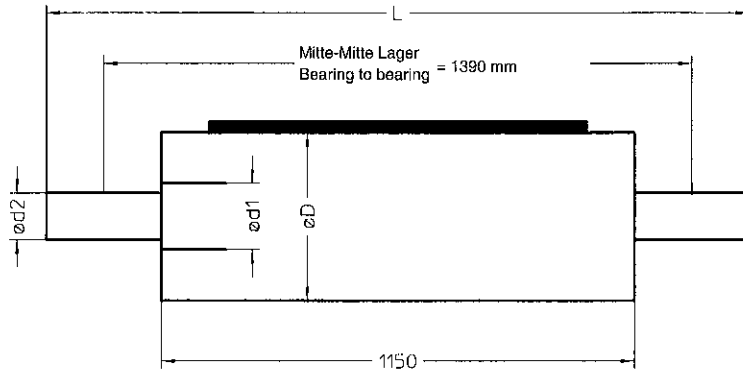

- Trommelmantel ballig
Pulley casing crowned
- Trommelmantel zylindrisch
Pulley casing cylindrical

**Bei Anfragen/Bestellungen bitte angeben
Please declare for requests/orders**

| Trommel ø Pulley ø D | Wellen ø / Shaft ø | | L | Masse in kg o. Lager/o. Belag Mass in kg without bearing/ without cover | Stehlagergehäuse Pillow block housing SNL | Lagerreihe Bearing series |
|--------------------------------|--------------------|-------------------------|------|---|---|------------------------------|
| | Nabe Hub d 1 | Lager Bearing d 2 | | | | |
| 270 321 | 60 | 40 | 1440 | 102 118 | 509 | 22209/H3 |
| 270 321 | 80 | 50 | 1446 | 130 145 | 511 | 22211/H3 |
| 270 321 403 | 100 | 60 | 1456 | 158 175 190 | 513 | 22213/H3 |
| 270 321 403 | 120 | 70 | 1466 | 208 229 277 | 516 | 22216/H3 |
| 270 321 403 | 130 | 80 | 1474 | 233 255 305 | 518 | 22218/H3 |

1- geschweißte Ausführung / 1 - Welded design

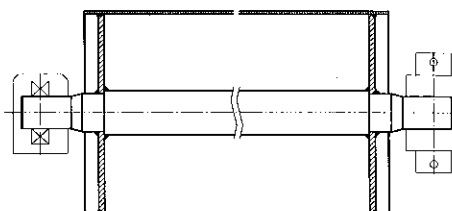

Trommelbeläge siehe Kapitel 1, Blatt-Nr. 1.00.41 / Pulley covers refer to chapter 1, Sheet No. 1.00.41

Bestellbeispiel: Trommelbezeichnung; GB; Tro.-Typ.; Tro.-ø; d1; d2; Gummibelag (Dicke; Oberfläche + SHORE „A“); mit oder ohne Stehlager; z. B.: UT, 1000; Typ 1, 403 mm ø, 130/80, 8 mm, glatt, SHORE 40°, mit SNL 518
Order example: Pulley designation: Belt width; pulley type; pulley ø; d1; d2; rubber cover (thickness, surface + SHORE „A“); with or without pillow block, e. g.: 1000, type 1, 403 mm, 130/80, 8 mm, smoth, SHORE 40°, with SNL 518

ANGETRIEBENE TROMMELN AUSSENGELAGERT DRIVING PULLEYS EXTERNAL BEARINGS



1000

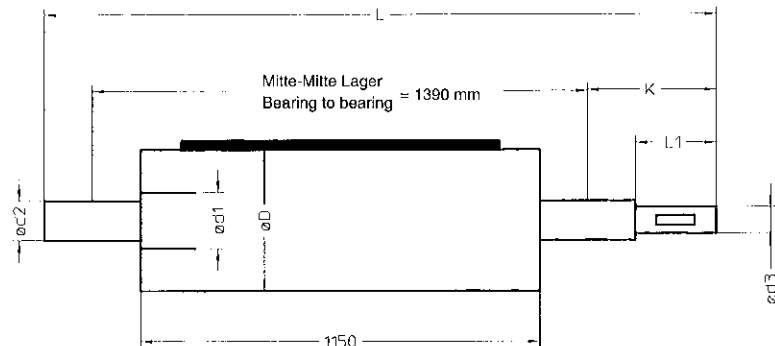

- Trommelmantel ballig
Pulley casing crowned
 - Trommelmantel zylindrisch
Pulley casing cylindrical
- Bei Anfragen/Bestellungen bitte angeben**
Please declare for requests/orders

| Trommel ø Pulley ø D | Spannsatz Bracing assembly d 1 | Wellen ø / Shaft ø Lager Bearing d 2 | Antrieb Gear d 3 | L | K | L 1 | Trommelart (Typ) Pulley design (Type) | Masse in kg o. Lager/o. Belag Mass in kg without bearing/without cover | Stahlager Typ Pillow block Type | Lagerreihe Bearing series |
|----------------------------|--------------------------------------|---|------------------------|------|-----|-----|--|---|--|------------------------------|
| 217 | 60 | 45 | 40 | 1541 | 125 | 70 | 2 | 104 | SNL 510 | 22210/H3 |
| 270 | 60 | 45 | 40 | 1541 | 125 | 70 | 2 | 130 | SNL 510 | 22210/H3 |
| 321 | 60 | 50 | 45 | 1556 | 138 | 80 | 2 | 142 | SNL 511 | 22211/H3 |
| 403 | 65 | 50 | 45 | 1556 | 138 | 80 | 2 | 196 | SNL 511 | 22211/H3 |
| 217 | 75 | 50 | 45 | 1556 | 138 | 80 | 2 | 132 | SNL 511 | 22211/H3 |
| 270 | 75 | 55 | 50 | 1573 | 153 | 90 | 2 | 157 | SNL 512 | 22212/H3 |
| 321 | 75 | 60 | 55 | 1578 | 155 | 90 | 2 | 178 | SNL 513 | 22213/H3 |
| 403 | 75 | 65 | 60 | 1592 | 168 | 100 | 2 | 223 | SNL 515 | 22215/H3 |
| 500 | 80 | 65 | 60 | 1592 | 168 | 100 | 2 | 257 | SNL 515 | 22215/H3 |
| 270 | 90 | 65 | 60 | 1592 | 168 | 100 | 2 | 196 | SNL 515 | 22215/H3 |
| 321 | 90 | 65 | 60 | 1592 | 168 | 100 | 2 | 222 | SNL 515 | 22215/H3 |
| 403 | 90 | 70 | 65 | 1608 | 180 | 110 | 4 | 243 | SNL 516 | 22216/H3 |
| 500 | 90 | 80 | 75 | 1642 | 210 | 130 | 4 | 281 | SNL 518 | 22218/H3 |
| 630 | 95 | 80 | 75 | 1642 | 210 | 130 | 4 | 374 | SNL 518 | 22218/H3 |
| 270 | 100 | 80 | 75 | 1642 | 210 | 130 | 2 | 225 | SNL 518 | 22218/H3 |
| 321 | 100 | 80 | 75 | 1642 | 210 | 130 | 2 | 252 | SNL 518 | 22218/H3 |
| 403 | 110 | 80 | 75 | 1642 | 210 | 130 | 2 | 332 | SNL 518 | 22218/H3 |
| 500 | 110 | 90 | 85 | 1668 | 230 | 140 | 4 | 311 | SNL 518 | 22218/H3 |
| 630 | 110 | 100 | 95 | 1701 | 258 | 160 | 4 | 410 | SNL 522 | 22222/H3 |
| 321 | 110 | 90 | 85 | 1668 | 230 | 140 | 2 | 276 | SNL 520 | 22220/H3 |
| 403 | 120 | 90 | 85 | 1668 | 230 | 140 | 2 | 358 | SNL 520 | 22220/H3 |
| 500 | 120 | 100 | 95 | 1701 | 258 | 160 | 4 | 341 | SNL 522 | 22222/H3 |
| 630 | 120 | 100 | 95 | 1701 | 258 | 160 | 4 | 430 | SNL 522 | 22222/H3 |
| 321 | 120 | 100 | 95 | 1701 | 258 | 160 | 2 | 307 | SNL 522 | 22222/H3 |
| 403 | 130 | 100 | 95 | 1701 | 258 | 160 | 2 | 398 | SNL 522 | 22222/H3 |
| 500 | 130 | 110 | 105 | 1729 | 283 | 180 | 4 | 382 | SNL 524 | 22224/H3 |
| 630 | 130 | 110 | 105 | 1729 | 283 | 180 | 4 | 474 | SNL 524 | 22224/H3 |
| 800 | 140 | 125 | 120 | 1766 | 313 | 200 | 3 | 610 | SNL 528 | 22228/H3 |
| 403 | 140 | 110 | 105 | 1729 | 283 | 180 | 2 | 428 | SNL 524 | 22224/H3 |
| 500 | 140 | 115 | 110 | 1745 | 295 | 190 | 2 | 502 | SNL 526 | 22226/H3 |
| 630 | 140 | 125 | 120 | 1766 | 313 | 200 | 4 | 511 | SNL 528 | 22228/H3 |
| 800 | 150 | 135 | 130 | 1798 | 340 | 220 | 3 | 647 | SNL 530 | 22230/H3 |
| 403 | 150 | 125 | 120 | 1766 | 313 | 200 | 2 | 483 | SNL 528 | 22228/H3 |
| 500 | 150 | 125 | 120 | 1766 | 313 | 200 | 2 | 558 | SNL 528 | 22228/H3 |
| 630 | 160 | 135 | 130 | 1798 | 340 | 220 | 4 | 571 | SNL 530 | 22230/H3 |
| 800 | 160 | 140 | 135 | 1821 | 358 | 230 | 4 | 712 | SNL 532 | 22232/H3 |
| 500 | 160 | 140 | 135 | 1821 | 358 | 230 | 2 | 629 | SNL 532 | 22232/H3 |
| 630 | 170 | 150 | 145 | 1850 | 380 | 250 | 4 | 705 | SD 3134 | 23134/H3 |
| 800 | 190 | 160 | 155 | 1865 | 395 | 260 | 4 | 935 | SD 3136 | 23136/H3 |
| 500 | 170 | 160 | 155 | 1865 | 395 | 260 | 2 | 714 | SD 3136 | 23136/H3 |
| 630 | 190 | 160 | 155 | 1865 | 395 | 260 | 4 | 822 | SD 3136 | 23136/H3 |
| 800 | 200 | 170 | 165 | 1910 | 425 | 280 | 4 | 1033 | SD 3138 | 23138/H3 |

2 – Nabe ohne Scheibe – Ausführung mit Spannsätzen
2 – Hub without disc – design with locking devices

3 – Standard – Ausführung mit Spannsätzen
3 – Standard – design with locking devices

4 – Turbinenböden – Ausführung mit Spannsätzen
4 – Turbine fixation – design with locking devices

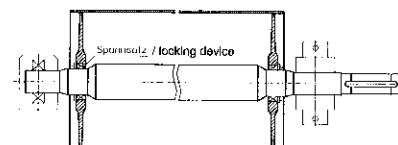
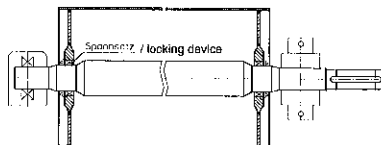
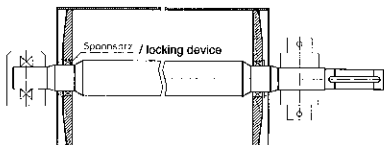

Trommelbeläge siehe Kapitel 1, Blatt-Nr. 1.00.41 / Pulley covers refer to chapter 1, Sheet No. 1.00.41

Bestellbeispiel: Trommelbezeichnung; GB; Tro.-Typ.; Tro.-ø; d1; d2; Gummibelag (Dicke; Oberfläche + SHORE „A“); mit oder ohne Stahlager; z. B.: AT, 1000; Typ 4, 630 mm ø, 140/125/120, 8 mm, ETR 70, mit SNL 528

Order example: Pulley designation; Belt width; pulley type; pulley ø; d1; d2; rubber cover (thickness; surface + SHORE „A“) with or without pillow block; e. g.: AT, 1000, type 4, 630 mm ø, 140/125/120, 8 mm, ETR 70, with SNL 530

**NICHT ANGETRIEBENE
TROMMELN AUSSENGELAGERT
NON-DRIVING PULLEYS
EXTERNAL BEARINGS**



1000

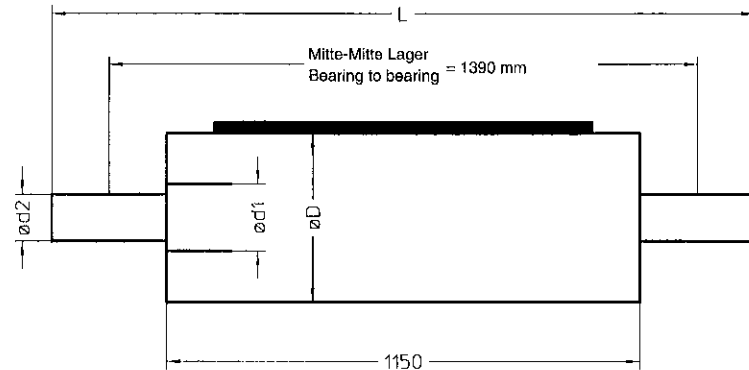

- Trommelmantel ballig
Pulley casing crowned
 - Trommelmantel zylindrisch
Pulley casing cylindrical
- Bei Anfragen/Bestellungen bitte angeben**
Please declare for requests/orders

| Trommel ø Pulley ø D | Wellen ø / Shaft ø Spannsatz Bracing assembly d 1 | Lager Bearing d 2 | L | Trommelart (Typ) Pulley design (Type) | Masse in kg o. Lager/o. Belag Mass in kg without bearing/without cover | Stehlagergehäuse Pillow block housing SNL | Lagerreihe Bearing series |
|---------------------------------|--|-------------------------|------|--|---|---|------------------------------|
| 217 270 321 403 | 60 | 40 | 1440 | 2 2 2 2 | 101 113 135 160 | 509 | 22209/H3 |
| 217 270 321 403 500 | 80 | 50 | 1446 | 2 2 2 2 2 | 132 153 171 192 251 | 511 | 22211/H3 |
| 270 321 403 500 630 | 90 | 60 | 1456 | 2 2 2 2 2 | 190 213 210 273 328 | 513 | 22213/H3 |
| 270 321 403 500 630 | 100 | 70 | 1466 | 2 2 2 2 2 | 219 244 310 296 384 | 516 | 22216/H3 |
| 321 403 500 630 | 110 | 80 | 1474 | 2 2 2 2 | 266 333 387 406 | 518 | 22218/H3 |
| 321 403 500 630 800 | 120 | 90 | 1486 | 2 2 2 2 2 | 283 350 405 435 514 | 520 | 22220/H3 |
| 403 500 630 800 | 130 | 100 | 1496 | 2 2 2 2 | 381 439 494 576 | 522 | 22222/H3 |
| 403 500 630 800 | 140 | 110 | 1502 | 2 2 2 2 | 409 467 517 681 | 524 | 22224/H3 |
| 500 630 800 | 150 | 125 | 1516 | 2 2 2 | 523 555 771 | 528 | 22228/H3 |
| 500 630 800 | 160 | 135 | 1526 | 2 2 2 | 557 617 794 | 530 | 22230/H3 |

2 – Nabe ohne Scheibe – Ausführung mit Spannsätzen
2 – Hub without disc – design with locking devices

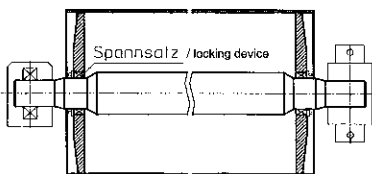

3 – Standard – Ausführung mit Spannsätzen
3 – Standard – design with locking devices

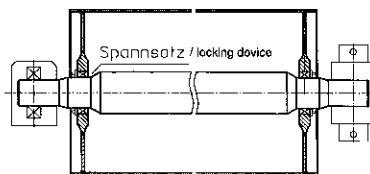

4 – Turbinenböden – Ausführung mit Spannsätzen
4 – Turbine fixation – design with locking devices

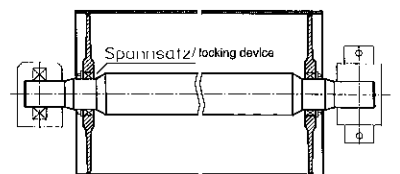

Trommelbeläge siehe Kapitel 1, Blatt-Nr. 1.00.41 / Pulley covers refer to chapter 1, Sheet No. 1.00.41

Bestellbeispiel: Trommelbezeichnung; GB; Tro.-Typ.; Tro.-ø; d1; d2; Gummibelag (Dicke; Oberfläche + SHORE „A“); mit oder ohne Stehlagern; z. B.: UT, 1000; Typ 2, 403 mm ø, 110/80, 10 mm, glatt, SHORE 40°; mit SNL 518
Order example: Pulley designation: Belt width; pulley type; pulley ø; d1; d2; rubber cover; (thickness, surface + SHORE “A”) with or without pillow block; e. g.: UT, 1000, type 2, 403 mm ø, 110/80, 10 mm, smooth, SHORE 40°; with SNL 518

NICHT ANGETRIEBENE TROMMELN INNENGELAGERT NON-DRIVING PULLEYS INTERNAL BEARINGS



1000

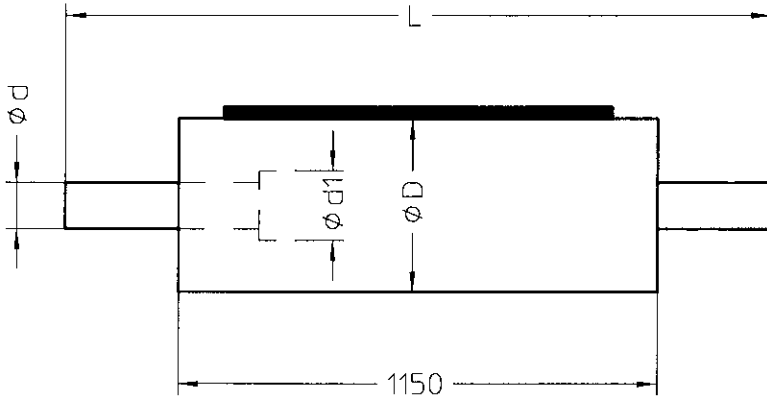

- Trommelmantel ballig
Pulley casing crowned
- Trommelmantel zylindrisch
Pulley casing cylindrical

Bei Anfragen/Bestellungen bitte angeben
Please declare for requests/orders

| Trommel ø Pulley ø | Wellen ø Shaft ø | | L | Masse in kg bei Trommelausführung Mass in kg of pulley execution | | |
|-----------------------|---------------------|-----|------|---|-----|-----|
| | D | d | | d1 | 1 | 2 |
| 270 | | 50 | 1350 | 79 | 81 | |
| | | 55 | 1350 | 86 | 87 | |
| | | 60 | 1350 | 96 | 98 | |
| | | 65 | 1350 | 103 | 105 | |
| | | 70 | 1400 | 111 | 114 | |
| 321 | | 55 | 1350 | 101 | 103 | |
| | | 60 | 1350 | 107 | 109 | |
| | | 65 | 1350 | 117 | 119 | |
| | | 70 | 1400 | 125 | 128 | 129 |
| | | 80 | 1400 | | 153 | 154 |
| 403 | | 60 | 1350 | 134 | 136 | |
| | | 65 | 1350 | 140 | 143 | |
| | | 70 | 1400 | 149 | 151 | 153 |
| | | 80 | 1400 | | 180 | 183 |
| | | 90 | 1400 | | | 206 |
| 500 | | 65 | 1350 | | 171 | |
| | | 70 | 1400 | | 180 | 182 |
| | | 80 | 1400 | | 198 | 201 |
| | | 90 | 1400 | | | 234 |
| | | 100 | 1400 | | | 256 |

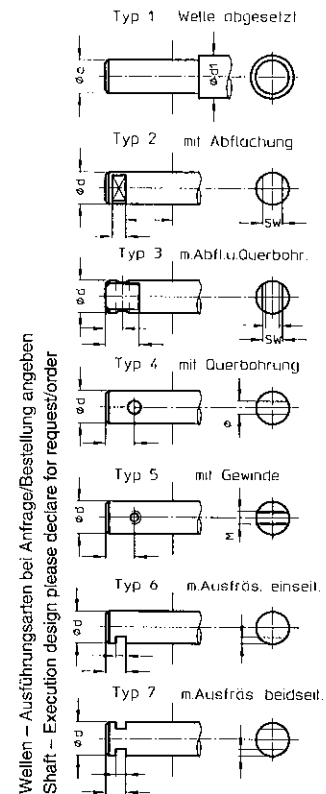

Wellen – Ausführungsarten bei Anfrage/Bestellung angeben
Shaft – Execution design please declare for request/order

1 – Ausführung – Flanschlager
1 – Design – Flange bearing

2 – Ausführung – Flanschlager
2 – Design – Flange bearing

3 – Ausführung – Nabe mit Scheibe
3 – Design – Hub with disc

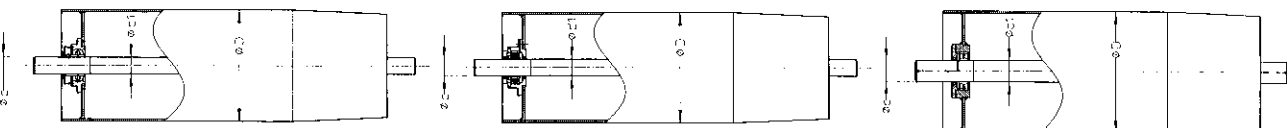

Trommelbeläge siehe Kapitel 1, Blatt-Nr. 1.00.41 / Pulley covers refer to chapter 1, Sheet No. 1.00.41

Bestellbeispiel: Trommelbezeichnung; GB; Tro.-Typ.; Tro.-ø; d; d1 (nur erforderlich, wenn d1 > als d); Gummibelag (Dicke; Oberfläche + SHORE „A“); z. B.: UT, 1000; Typ 2-iv., 321 mm ø, 60, 10 mm, glatt, SHORE 40°
Order example: Pulley designation: Belt width; pulley type; pulley ø; d; d1; (only necessary when d1 > than d); rubber cover (thickness, surface and SHORE “A”); e. g.: UT, 1000; type 2-iv., 321 mm ø, 60, 10 mm, smooth, SHORE 40°